

**GROUND FLOOR PLAN
(1:50)**

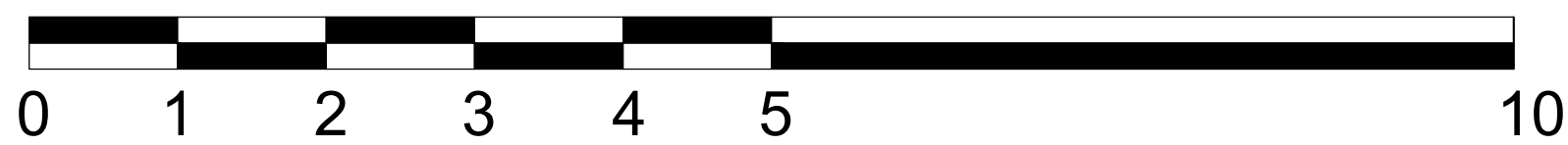

SCALE BAR 1:50

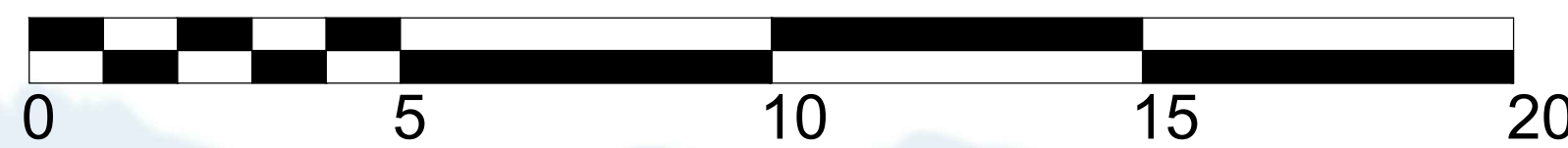

SCALE BAR 1:100



**SOUTH ELEVATION
(1:100)**



**EAST ELEVATION
(1:100)**

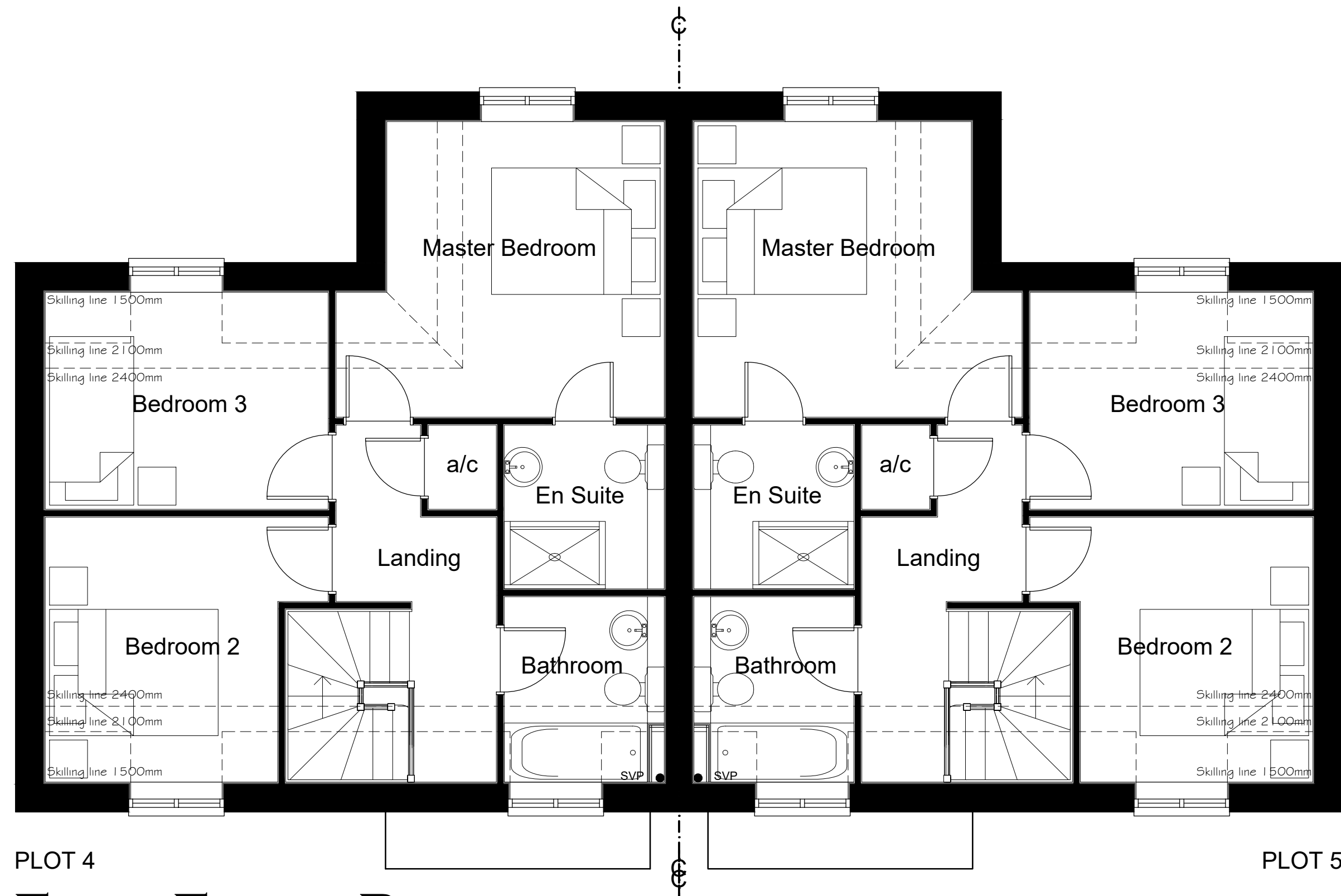

**FIRST FLOOR PLAN
(1:50)**

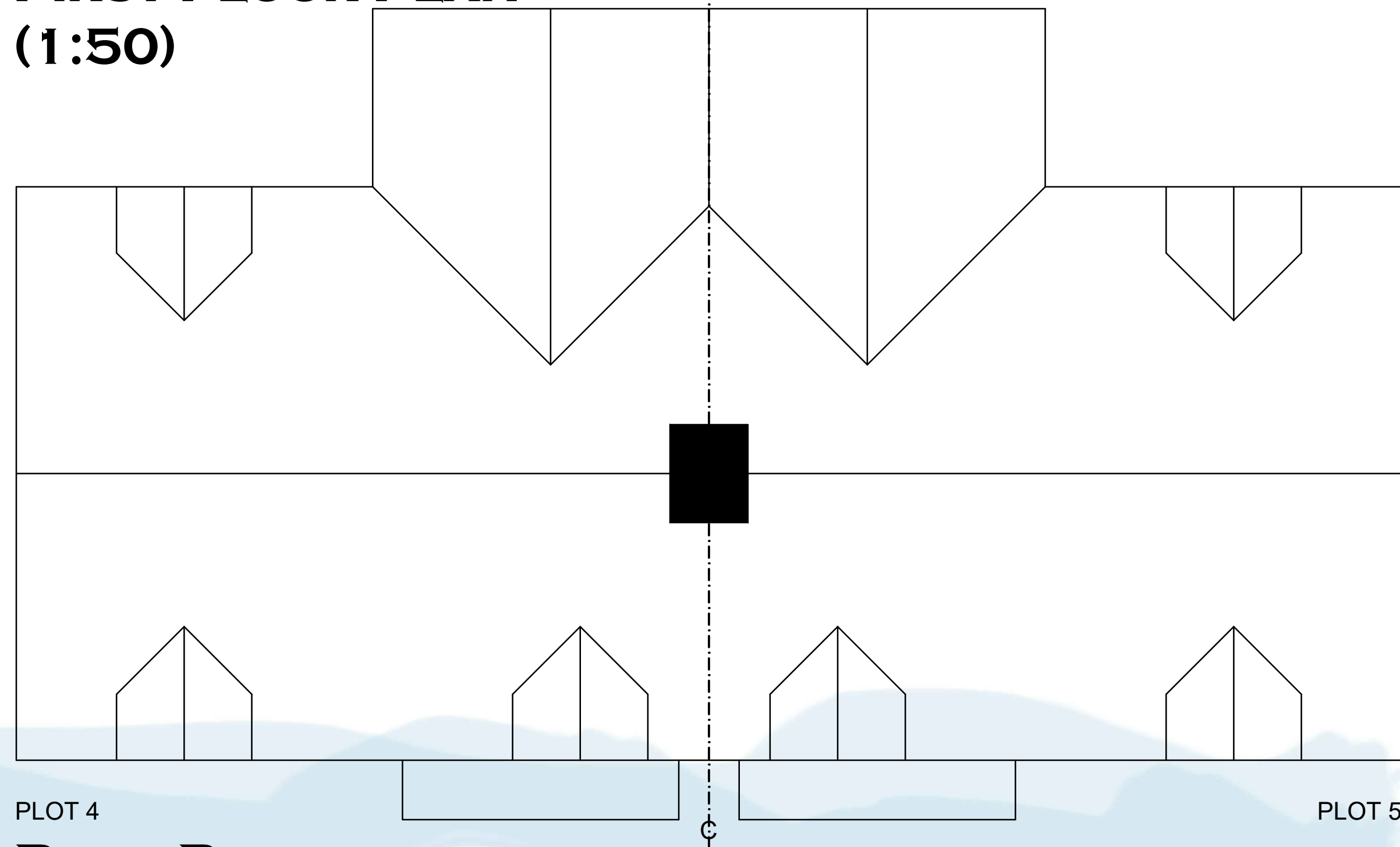

**ROOF PLAN
(1:50)**



**NORTH ELEVATION
(1:100)**



**WEST ELEVATION
(1:100)**

Notes

THIS DRAWING IS THE COPYRIGHT OF VIVID DESIGN STUDIO LTD AND MUST NOT BE COPIED, ALTERED OR REPRODUCED IN ANY WAY NEITHER PASSED TO A THIRD PARTY WITHOUT THEIR WRITTEN PERMISSION.

DIMENSIONS TO BE CHECKED ON SITE BEFORE COMMENCING WORK AND ANY DISCREPANCIES SHALL BE REPORTED TO THE DESIGNER. FIGURED DIMENSIONS MUST BE TAKEN IN PREFERENCE TO SCALED DIMENSIONS.

Rev:-	Description:-	Date:-	Chkd by:-
A	Omitted ground floor side windows	21/02/25	



The Barn, Calcot Mount Business Park, Calcot Lane,
Curdridge, Southampton, Hampshire, SO32 2BN
Tel: 01489 786670
Email: info@vividdesignstudio.co.uk
Website: www.vividdesignstudio.co.uk

Project:-	Proposed Residential Development Longacre The Street Walberton West Sussex		
Title:-	Proposed Floor Plans & Elevations (Plot 4&5)		
Client:-	Maxwell Homes Winchester Ltd		
Scale:-	1:50, 1:100 (@A1)		
Drawn By:-	PJD	Checked By:-	PJD
Date:-	21/10/24	Date:-	21/10/24
Job.No:-	220043	Drg.No:-	07
		Rev:-	A