

### CURRENT LAYOUT

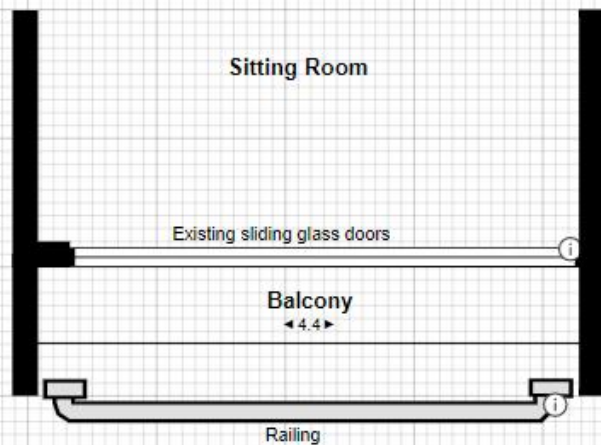

### PROPOSED LAYOUT

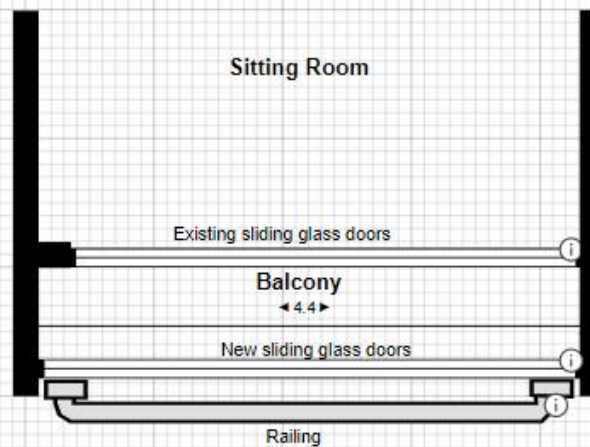

#### **Notes**

Second floor - Flat 12 Climping Court, Rackham Road, Rustington, West Sussex. BN16 2LQ

The balcony is currently enclosed on four sides.

The proposal is to add a second set of sliding doors inside the existing balcony railing. See photos below...

