

GARAGE SECTION BB

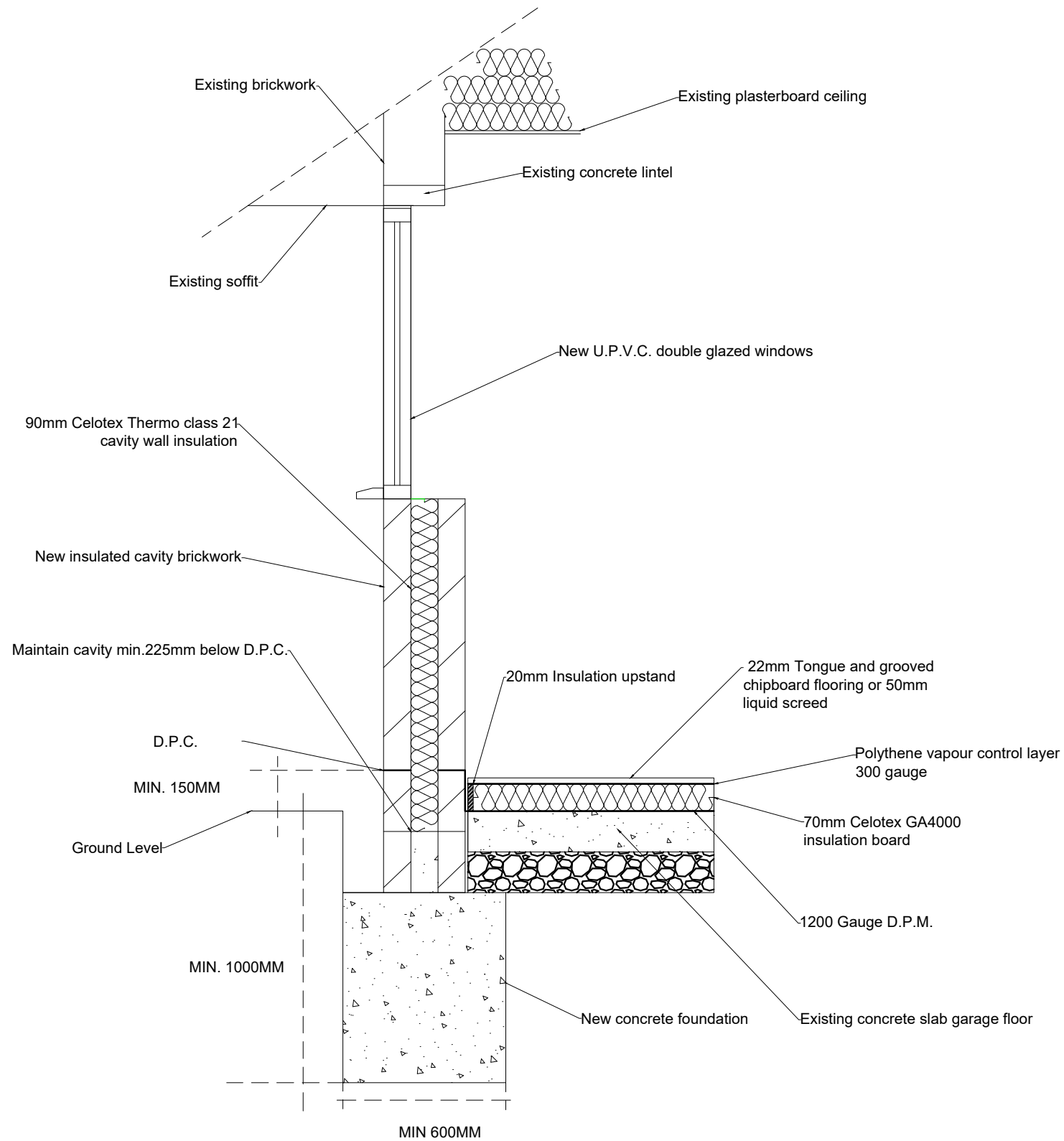

DESCRIPTION OF WORKS;

To convert the existing integral garage into a habitable room. The garage doors are to be removed and replaced with insulated cavity walls & U.P.V.C. Double glazed windows. All new walls shall be drylined and plastered. New room floor to be an insulated floating or liquid screed floor.

SPECIFICATION;

FOUNDATIONS: Mass concrete foundations to a min.depth of 1000mm. width 600mm, but to suit soil conditions & any trees as agreed with building control inspector. Concrete mix 1:3:6 to be poured to 450mm below existing d.p.c level. Depth must be 150mm lower than any adjacent drains. Should any drains be within 3 metres of the foundation, local water authority must be informed and a Declaration of Works be sort.

WALLS: All load bearing masonry shall be in accordance with BS 5628 and non load bearing masonry to BS 8200. Below G.L cavity construction of 'Thermalite' standard blwk, or dense conc. blwk. Lean mix concrete cavity fill to min. 225mm below d.p.c.. Above G.L. outer skin of facing brickwork to match existing. 100mm cavity to be with 90mm 'Celotex Thermo class 21' cavity batts (0.18 Wm2k) and inner skin of 'Thermalite' turbo insulation blockwork. All new walls to be drylined with 12.5mm plbd & set. Cavities running continuously. 225mm long stainless steel wall ties @750mm horizontally, 450mm vertically and 225mm c/c @reveals. Insulated cavity closures at reveals. Bed 100mm horizontal d.p.c. min. 150mm above G.L.

This drawing is for the purpose of planning and building control. Do not scale from this drawing for construction. The builder is responsible for checking on site all dimensions and relevant information prior to the commencement of work

PLAN2BUILDSUSSEX.CO.UK
TEL: 01243 26 73 25

Mr. & Mrs. Leadston
5 Downlands Close, Pagham
West Sussex PO21 3QA
GARAGE SECTION BB A3 PAPER
Date: Aug. 2025 Scale 1:30 Dwg.no. G.SE.BB 01