

Notes

CDM REGULATIONS 2015  
The client must abide by the Construction Design and Management Regulations 2015. The client must appoint a contractor. If more than one contractor is to be involved, the client will need to appoint (in writing) a principal designer (to plan, manage and coordinate the planning and design work) and a principal contractor (to plan, manage and coordinate the construction and ensure there are arrangements in place for managing and organising the project).

Domestic clients  
The domestic client is to appoint a principal designer and a principal contractor when there is more than one contractor, if not your duties will automatically transfer to the contractor or principal contractor.

The designer can take on the duties, provided there is a written agreement between you and the designer to do so.

The Health and Safety Executive is to be notified as soon as possible before construction work starts if the works:

- (a) Last longer than 30 working days and has more than 20 workers working simultaneously at any point in the project.

Or:

- (b) Exceeds 500 person days.

All contractors/sub-contractors must ensure that they are in possession of the currently issued drawings and details before commencing the relevant work-stage. All measurements to be checked before work starts, any discrepancies must be reported to the architect immediately. Alterations can be made prior to commencement of building works.

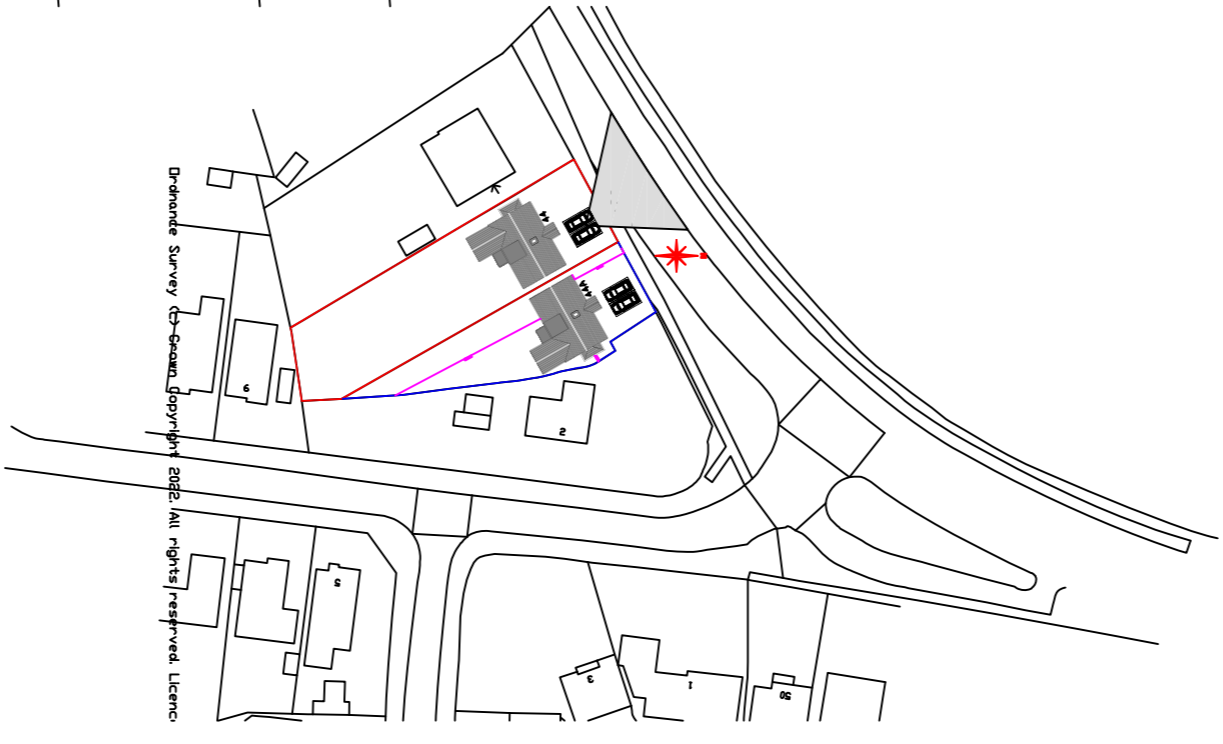

No.	Revision/Issue	Date.

  
**MULBERRY ARCHITECTURE LTD**  
 info@mulberrybg.co.uk  
 01243 824814

44 Popham Road  
Popham  
Bognor Regis  
West Sussex  
PO21 4NP

Proposed 4 Bed Chalet Bungalow

Date  
September 2025  
Scale  
1:200

Ordnance Survey (c) Crown Copyright 2022. All rights reserved. Licence number 100022432