

Ground Floor Plan

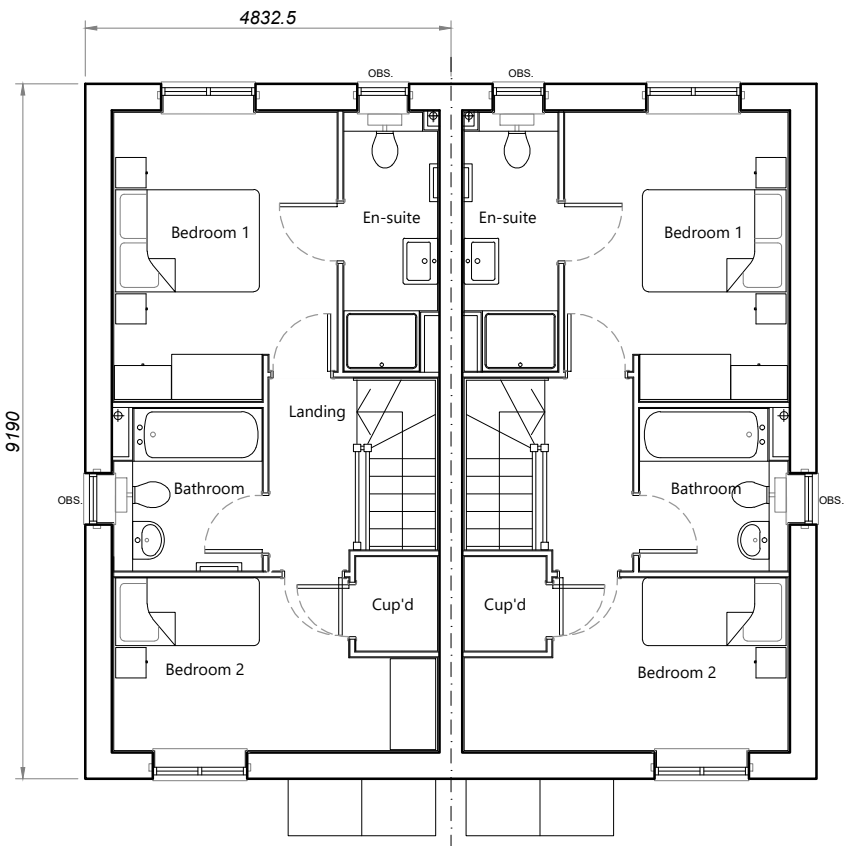

First Floor Plan

House Type	C	Variation	1	Option	
Bedrooms	2	Persons			3
Sq.ft	792	Sq.m			73.58

PLOT No.

As Drawn - 67-68

Handed -



Romsey	T:01794 367703	Rev	Description	Date	Au	Ch
Portishead	T:01275 407000	A	Issued for Planning	08.11.24	CJB	CI
London	T:01794 367703	B	Text position corrected. Plot numbers updated	31.01.25	CMI	

www.thrivearchitects.co.uk

This drawing is the copyright of Thrive Architects Ltd ©. All rights reserved. Ordnance Survey Data © Crown Copyright. All rights reserved. Licence No. 100007359. Permission is granted to scale from this drawing for the purposes of Local Authority Planning Applications only. For all other purposes DO NOT scale from this drawing. Contractors, sub-contractors and suppliers are to check all relevant dimensions and levels of the site and building before commencing any shop drawings or building work. Any discrepancies should be recorded to the Architect. Where ARUN DISTRICT COUNCIL MEMBERS in conjunction with the Consultants' drawings / Clients' Construction Specification.

Project	Land West of Pagham Road		
Drawing	House Type C - 2 Block - Variation 1 Floor Plans		
Client	Bargate Homes		
Job no.	BARG230419	Date	10.09.24
Dwg no.	HT.C(2blk)-1.p	Rev.	B
Author	CJB	Checker	
Status	PLANNING	Scale	1:100 at A3
Client ref.		Office	Romsey

