

m3
 mayer brown
 Mayer Brown Limited
 Lion House, Oriental Road, Woking, Surrey GU22 8AR
 Telephone 01483 750 506
 enquiry@mayerbrown.co.uk www.mayerbrown.co.uk

client
 PERSIMMON HOMES THAMES VALLEY

project
 PHASE 6B
 LITTLEHAMPTON

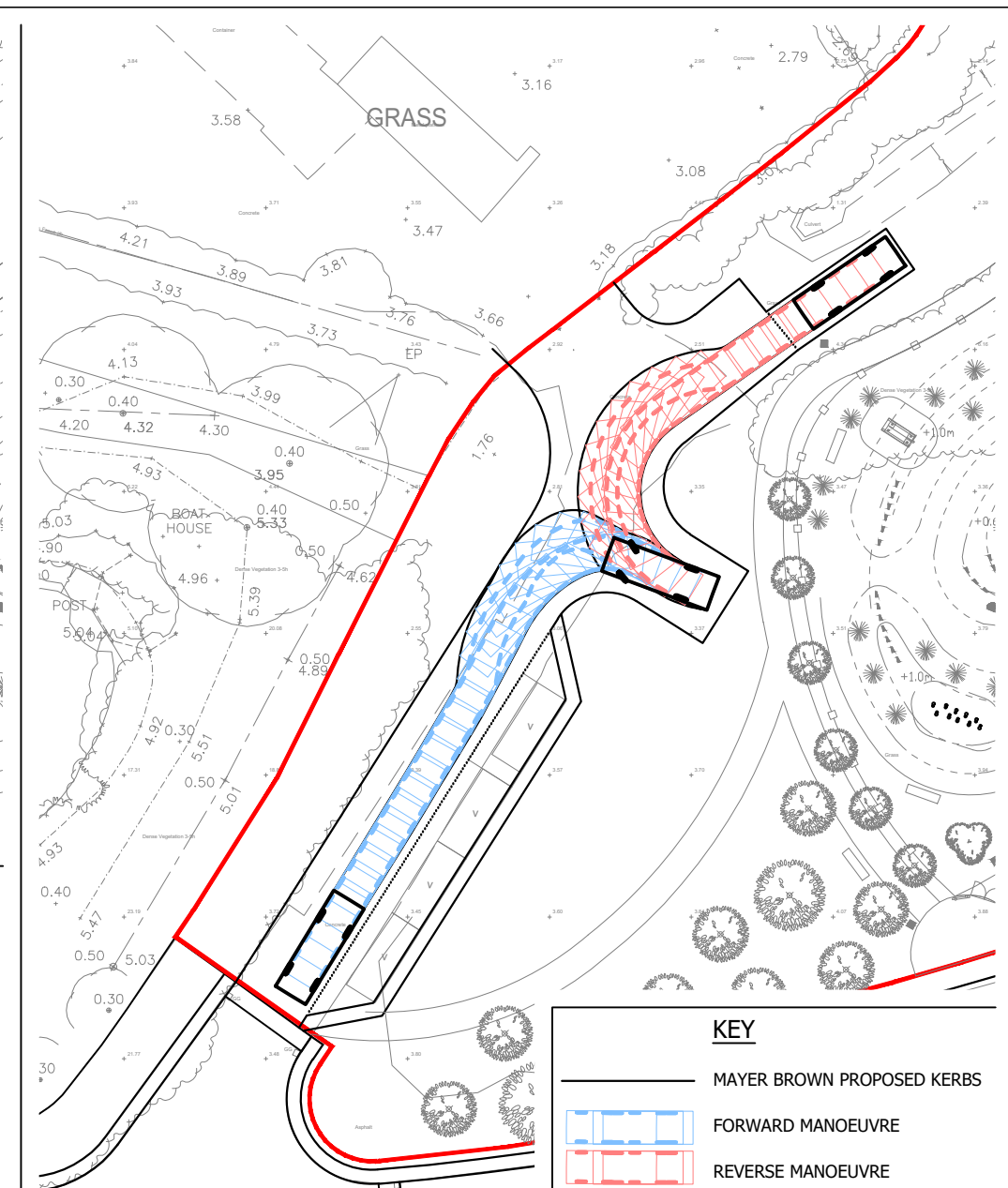

title
 SWEPT PATH ANALYSIS
 PUMPING APPLIANCE
 ENTERING / EXITING LOADING BAY

scale 1:500 @ A4
 drawn by TC
 checked by SF

date DECEMBER 2025
 cad file TK04.DWG
 suitability -
 rev. P1

drawing number
 PHLITTLEPH6B.2/TK04