

DB32 Fire Appliance
Overall Length 8.680m
Overall Width 2.180m
Overall Body Height 3.452m
Min Body Ground Clearance 0.337m
Max Track Width 2.121m
Lock to lock time 6.00s
Kerb to Kerb Turning Radius 7.910m

KEY

- MAYER BROWN PROPOSED KERBS
- HOSE LENGTH
- FORWARD MANOEUVRE
- REVERSE MANOEUVRE

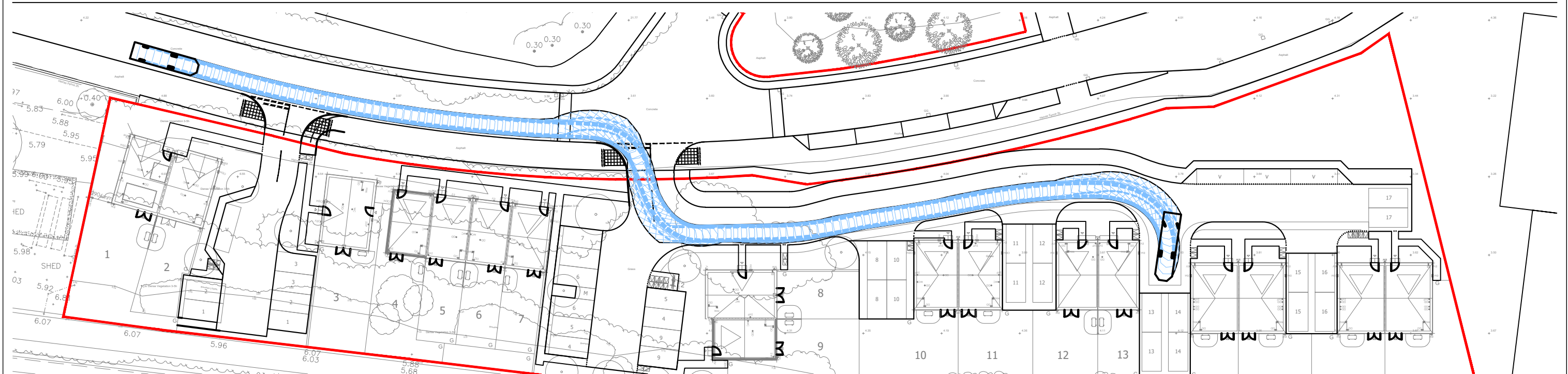

© Crown copyright, all rights reserved. 2025. Licence number AC0000808122.



Mayer Brown Limited
Lion House Oriental Road Woking Surrey GU22 8AR
Telephone 01483 750 508
enquiry@mayerbrown.co.uk www.mayerbrown.co.uk

client
PERSIMMON HOMES THAMES VALLEY

project
PHASE 6B
LITTLEHAMPTON

title
SWEPT PATH ANALYSIS
DB32 FIRE APPLIANCE
ENTERING / EXITING SITE AND USING TURNING HEAD

scale 1:500 @ A3	drawn by TC	checked by SF
date created DEC 2025	date revised -	cad file TK02.DWG
drawing number	suitability -	rev. P2

PHLITTLEPH6B.2/TK02