

Section 1:200 @ A3

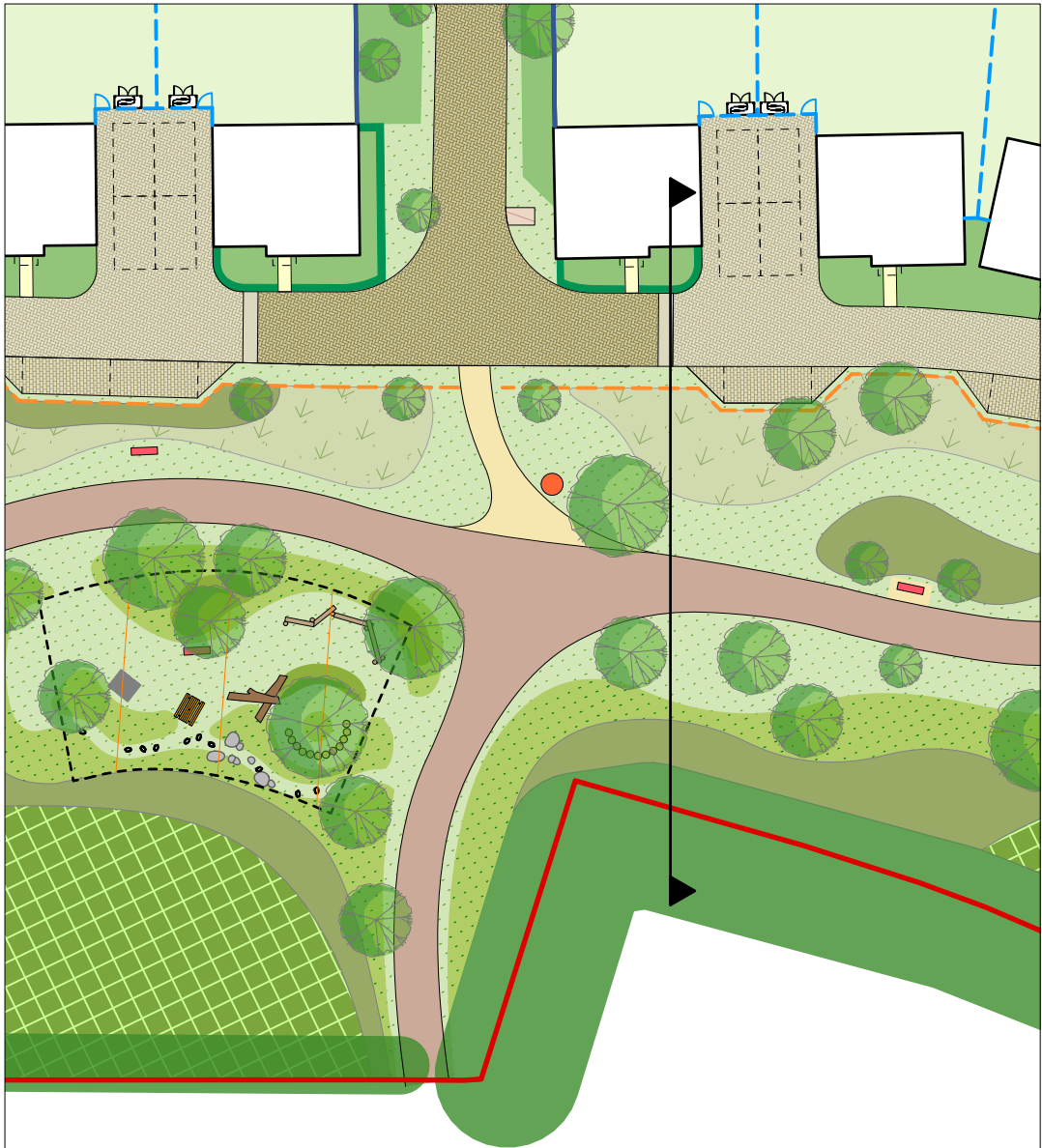
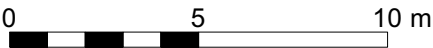

Plan 1:500 @ A3

- RM4 Boundary**
- Cleft chestnut post and 2 rails fence 1.2m high
- Mews Street: Charcon Woburn Original in Brindle, 200x134mm, 45deg herringbone
Kerb: Charcon Eco Countryside Kerb 145x255mm, 50mm upstand
- Semi Private Drives: Charcon Woburn Original in Rustic, 200x134mm, 45deg herringbone
Kerb: Charcon Eco Countryside Classic Flat Top Edging 50x250mm, 50mm upstand
- Parallel parking bays: Charcon Woburn Original in Brindle, 200x134mm, stretcher bond
Kerb: Charcon Eco Countryside Kerb 145x255mm, 50mm upstand
- Parallel parking bays: Charcon Woburn Original in Rustic, 200x134mm, stretcher bond
Kerb: Charcon Eco Countryside Kerb 145x255mm, 50mm upstand
- Driveways: Charcon Woburn Rumbled in Autumn, 200x134mm, stretcher bond
- Rumble Strips: Charcon Woburn Original in Graphite, 200x134mm, stretcher bond
- Private footpaths: Charcon Stonemaster Flag, 450x450mm in sandy buff, stack bond
- Public Footpath: Compacted hoggins, variable width, Timber edging
- Macadam surface footpath/cycleway, 3m wide
Kerb: Charcon British Standard Flat Top Edging 50x250mm, laid flush
- Bin Collection Points: Charcon Woburn Rumbled in Autumn, 134x134mm, stack bond
- Extent of equipped and natural play area (Indicative layout shown. To be designed by play specialist and coordinated with Arun District Council through conditions)
- Timber picnic bench
- Proposed bench
- Waste bin
- Existing vegetation to be retained (Refer to arboriculturists AIA)
- Proposed trees
- Low single-species hedgerow
- Native scrub
- Woodland structure planting
- Amenity grass
- Long grass margins
- Wildflower meadow
- Private ornamental planting
- Rear gardens
- Private front lawn

Ford Airfield
Vistry



Climping Edge Transect
RM4

Status:	Drawn by:	Checked by:
For Planning	DL	TF
Project Number:	Scale @ A3:	Date:
180641	1:500	08/2024
Drawing Number:	Revision:	
TOR-RM4-XX-DR-L-P-029	A	

© tor&co 2024

Do not scale from this drawing

tor
&co

Everdene House
Deansleigh Road
Bournemouth BH7 7DU
020 3664 6755
enquiries@torandco.com
www.torandco.com