



Distribution and types of play features shown indicatively, to be agreed in consultation with Arun District Council and secured by condition

● Individual play experience features

Climping Edge LAP

Local Area for Play (LAP) / Doorstep play

Target age group: Under 6's

Total designated space: 650Sqm

Theme: Exploration and discovery / exploration of the natural world - the play area will encourage young children to explore their local natural environment. Located in the woodland edge and with hibernaculas located close by to encourage breakout and exploration of the landscape.

Target skills development: Fine motor skills / discovery /

Number of play experiences: 13no.

Play features / experiences (subject to consultation and coordination of final design – to be agreed via condition):

- Interactive panels – nature spotting boards
- Bug hotel
- Investigation table
- Play hut /den
- Wigwam posts
- Minibeast tower
- Magnifying post

Other features to be included / notes:

- Bench seating for supervising adults
- Bins
- Mounding, amenity grass areas to provide spill out / flexible and supervised playable space
- LAP to be situated within and adjacent to the woodland belt, encouraging exploration.
- Ornamental planting
- Deciduous trees for summer shade
- Shrub planting providing enclosure and wind buffering

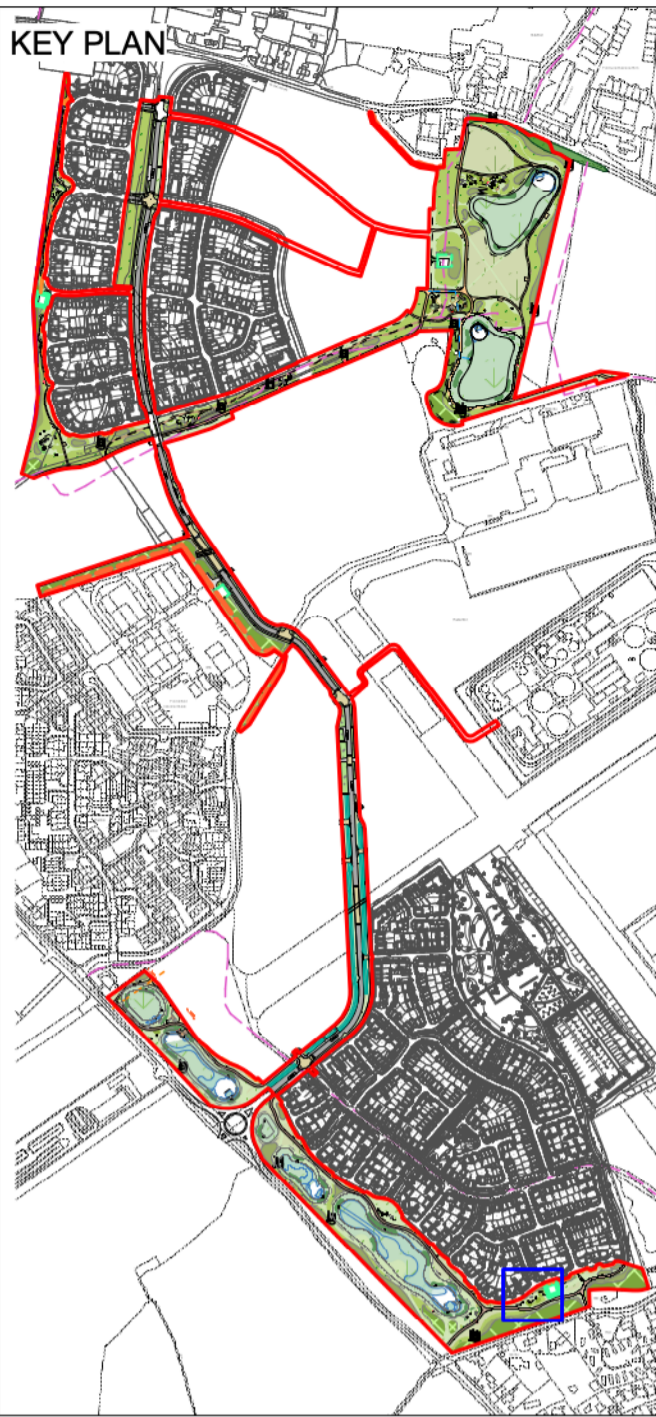

- RM4 Boundary
- Extent of equipped and natural play area
- 3m wide Cycleway/footpath: Type 1 limestone surface course with 25mm lime dust dressing course.
- Cleft chestnut post and 2 rails fence 1.2m high
- Steel wire mesh security fence in green 1.8m high
- Timber picnic bench
- Proposed bench
- Waste bin
- Existing vegetation to be retained (Refer to arboriculturists AIA)
- Proposed trees
- Native scrub
- Woodland structure planting
- Native hedgerow
- Play area ornamental planting
- Amenity grass
- Long grass margins
- Wildflower meadow

Ford Airfield
Vistry



Play Provision Climping Edge
Reserved Matters Infrastructure

Status:	Drawn by:	Checked by:
For Planning	DL	TF
Project Number:	Scale @ A1:	Date:
180641	1:250	12/2024
Drawing Number:		Revision:
TOR-RMIN-XX-DR-L-P-018		

© Crown Copyright and database rights 2024 OS Licence no. AC0000849896

© tor&co 2024 Scale for planning purposes only

tor
&co

Everdene House
Deansleigh Road
Bournemouth BH17 7DU
020 3664 6755
enquiries@torandco.com
www.torandco.com