

Notes
 All dimensions are in millimeters unless noted otherwise.
 All dimensions to be checked on site.
 The design shown on this drawing is the property of WDS and is not to be used or the drawing copied, communicated or disclosed, in whole or in part, except in accordance with a contract, licence or agreement in writing with WDS Ltd.

Revision Notes:

External fabric Notes:-
 Roofs to be Kingspan Top Deck KS1000 TD 100mm insulation (138mm O/A) to achieve U value of 0.18 at roof pitches indicated on sections.
 Walls to be Kingspan KS1000 Microb 80mm laid horizontal fixed sheeting rails to achieve U value 0.24.
 Curtain walling to be double glazed aluminium framed to achieve U value of 1.6.
 (Glass specification to be advised by SBEM calculation)
 Steel frame, purlins & sheeting rails to be designed by Structural Engineer.

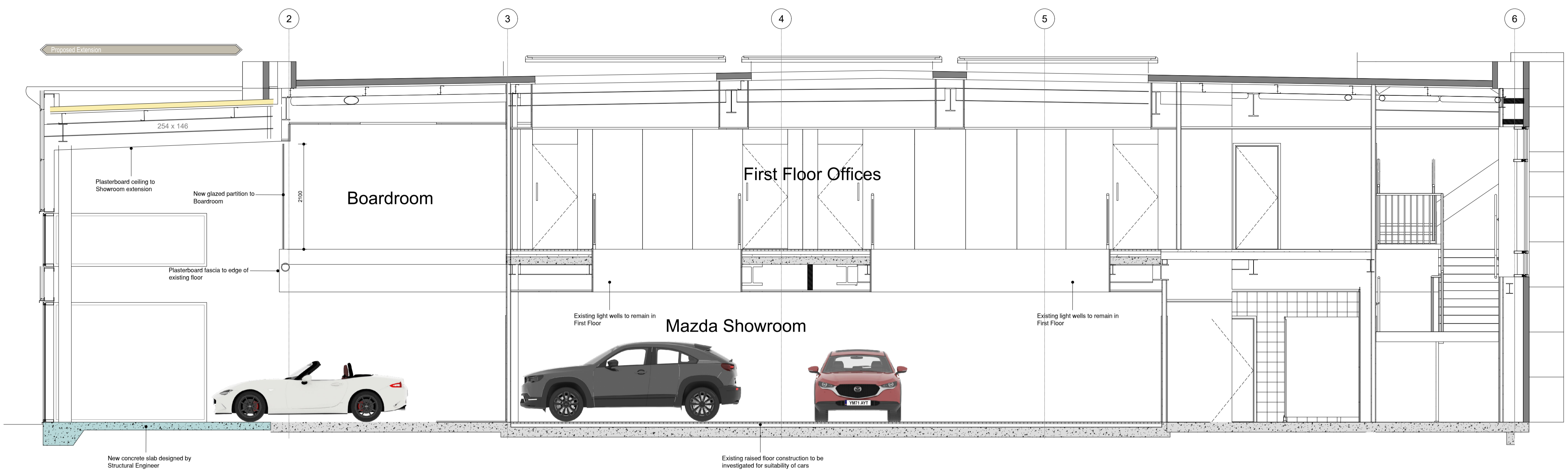

Proposed Section A-A



Proposed Visual

Client: Yeomans
 Date: July 2025
 Scale: 1:50 @ A1
 Project: Proposed Mazda, Littlehampton Road, Ferring, Worthing, BN12 6PB
 Drawing Title: Section & Visual

Drawing No. G002-13
 Rev. -

DESIGN SOLUTIONS

Commer House
 Tadcaster Enterprise Park
 Station Road
 Tadcaster LS24 99F
 M. 07974 936313
 T. 01937 222133
 E. keith@wdesignsolutions.co.uk