



View 1



View 8



View 9



View 10



View 11



View 12



View 2



View 3



View 4



View 5



View 6



View 7

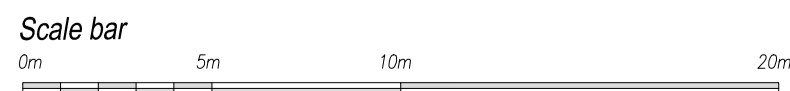
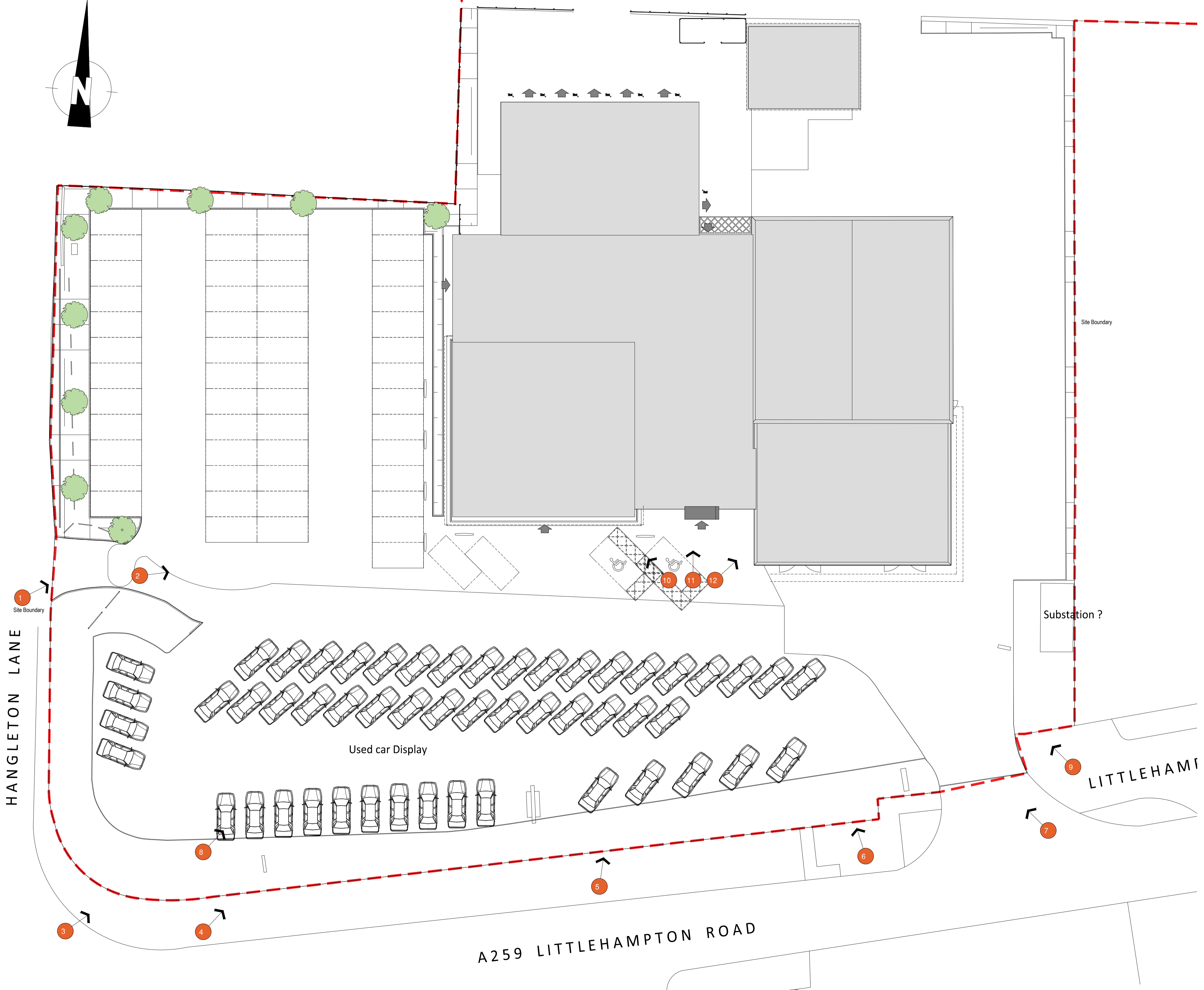
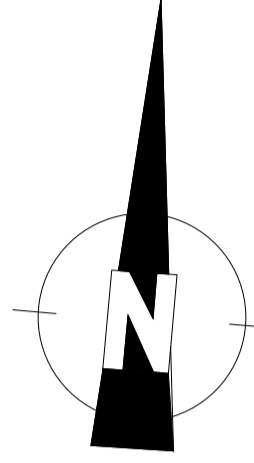

Notes
 All dimensions are in millimeters unless noted otherwise.
 All dimensions to be checked on site.
 The design shown on this drawing is the property of WDS and is not to be used or the drawing copied, communicated or disclosed, in whole or in part, except in accordance with a contract, licence or agreement in writing with WDS Ltd.

Revision Notes:

Client: Yeomans
 Date: June 2025
 Scale: 1:200 @ A1
 Project: Proposed Mazda, Littlehampton Road, Ferring, Worthing, BN12 6PB
 Drawing Title: Existing Site Plan

Drawing No. G002-01 Rev.

Commer House
 Tadcaster Enterprise Park
 Station Road
 Tadcaster LS24 99F
 M. 07974 936313
 T. 01937 222133
 E. keith@wdsolutions.co.uk