

DRAWINGS

- PL100** Site Location Plan
- PL200** Topographic Survey with Contours
- PL300** Existing Drainage
- PL400** Impermeable Areas
- PL500** Conceptual Drainage Strategy

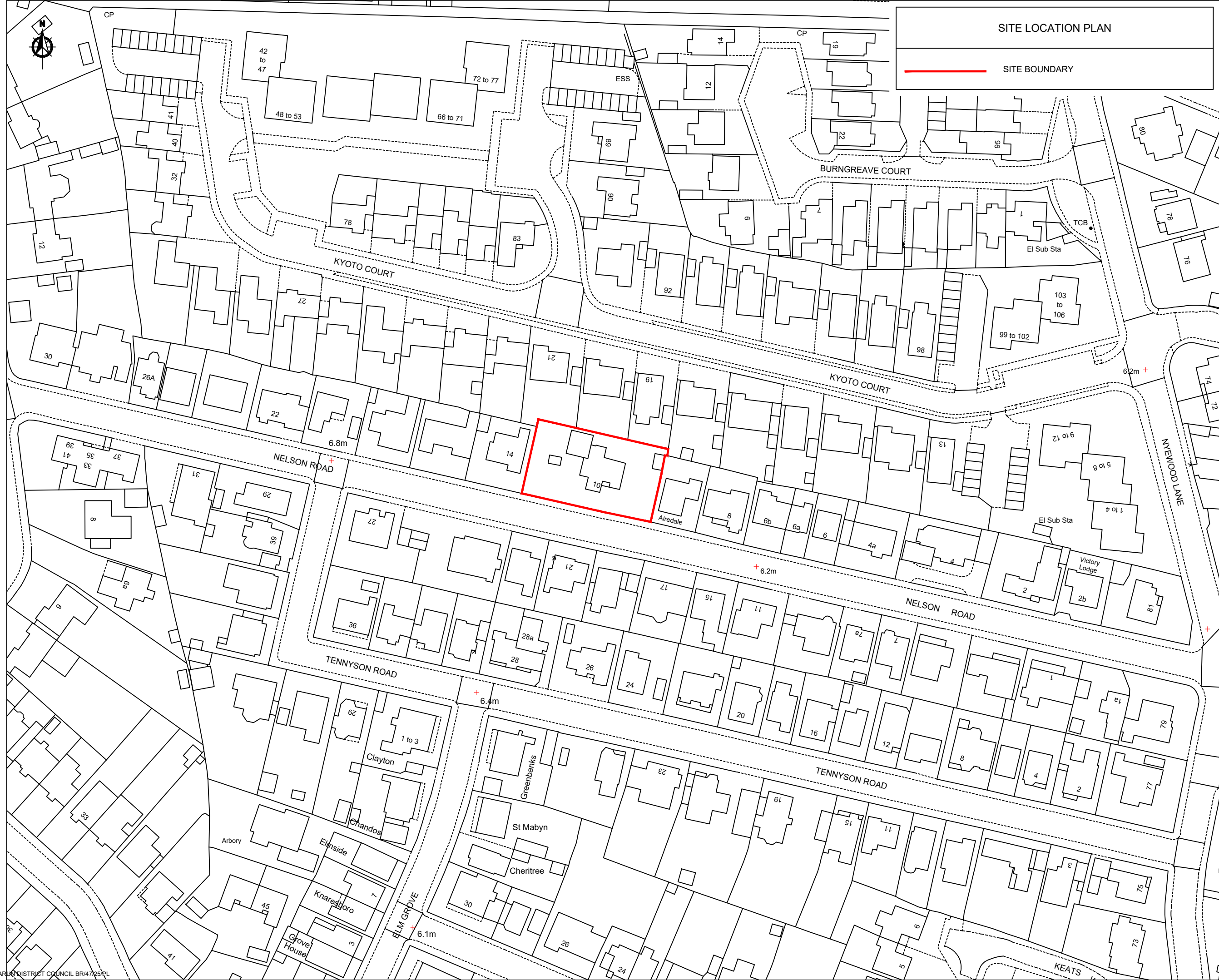

SITE LOCATION PLAN

SITE BOUNDARY

NOTES

A3

1. This drawing is to be read in conjunction with all other BP Civils drawings, and with all relevant Architect's and Engineer's drawings and specification. Any discrepancies found are to be reported immediately to the Engineer.
2. BP Civils accepts no responsibility for inaccuracies in data provided by third parties such as topographic surveys or Ordnance Survey mapping.
3. Do not scale, work to figured dimensions only. All dimensions are in millimeters unless noted otherwise and all levels are in metres from the topographic survey datum.
4. Any information given regarding existing underground services is given in good faith after consultation with the relevant authority, however accuracy is not certain. The main contractor is responsible for checking all information on site prior to work commencing and taking due care whilst undertaking the works.
5. All dimensions to be checked on site. All details and dimensions relating to sub-contractors work must be checked and agreed between the sub-contractor or supplier and the general contractor.
6. The electronic information from this drawing can not be guaranteed as dimensionally drawn exact. Figured dimensions must be used for setting out and detailing. BP Civils logos and company information must be removed from copies if information is re-used.
7. Where used, this map is based on or reproduced from Ordnance Survey material with the permission of Ordnance Survey on behalf of the controller of His Majesty's Stationary Office (c) Crown Copyright. Licence number: 100022432. BP Civils accept no liability for any inaccuracies with the data.

-	-	Original Issue
Rev.	Date	Amendments



BP CIVILS

Infrastructure Design and Transport Planning Consultants
2 West Barn, Norton Lane, Chichester, West Sussex PO20 3AF
Tel: 01243 210418
www.bpcivils.co.uk enquiries@bpcivils.co.uk

Drawing Status	PLANNING NOT FOR CONSTRUCTION		
Client	A, G & J Steventon		
Project	10-12 Nelson Road, Bognor Regis		
Drawing Title	Site Location Plan		
Scale at A3	Date	Drawn By	Checked By
1:200	Feb. '24	SPB	MJA
Drawing Code	Drawing No.		Rev.
000-BPC-WD-ZZ-D-C	PL100		P-

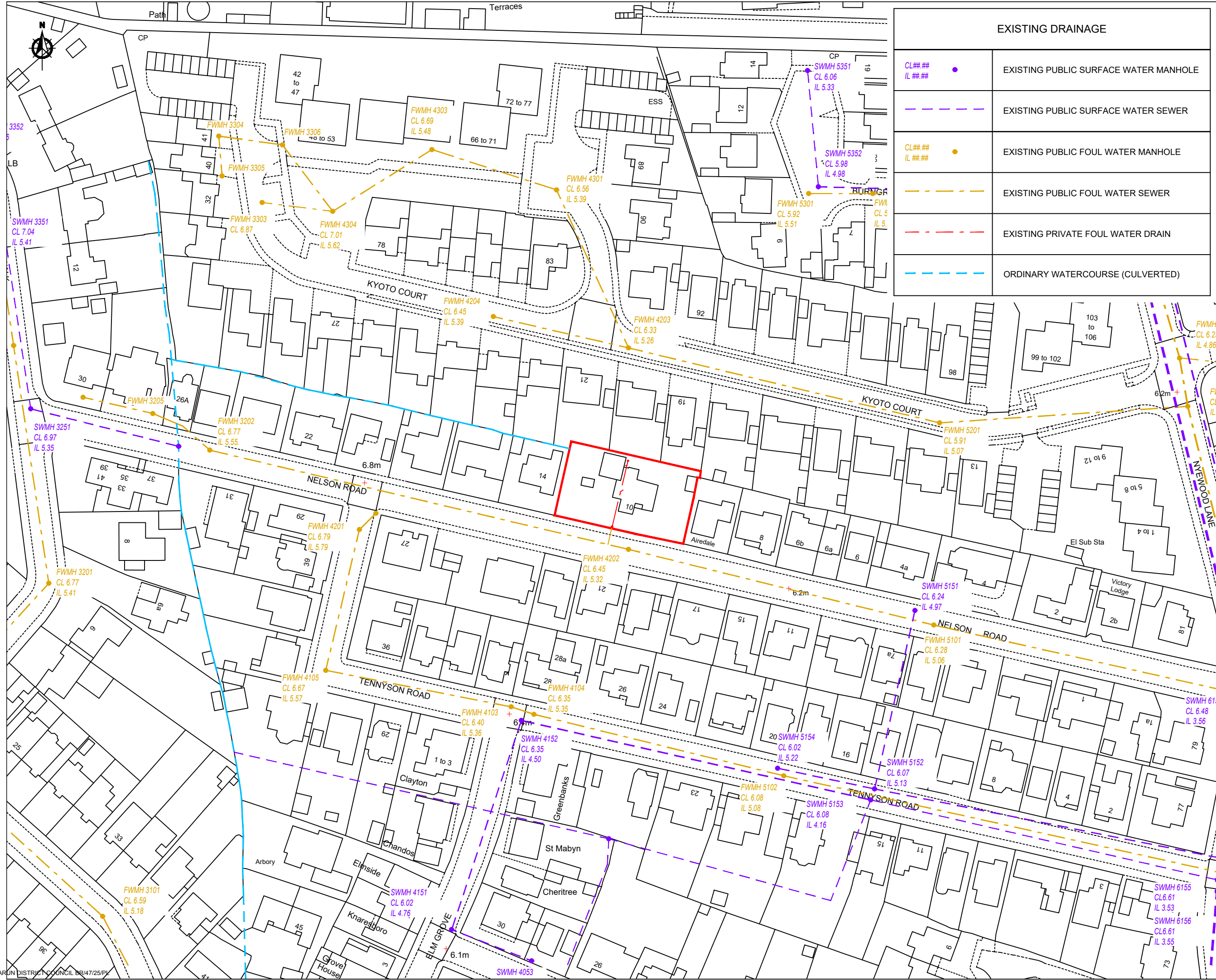

EXISTING DRAINAGE	
CL##.## IL ##.##	EXISTING PUBLIC SURFACE WATER MANHOLE
---	EXISTING PUBLIC SURFACE WATER SEWER
CL##.## IL ##.##	EXISTING PUBLIC FOUL WATER MANHOLE
---	EXISTING PUBLIC FOUL WATER SEWER
---	EXISTING PRIVATE FOUL WATER DRAIN
---	ORDINARY WATERCOURSE (CULVERTED)

NOTES

1. This drawing is to be read in conjunction with all other BP Civils drawings, and with all relevant Architect's and Engineer's drawings and specification. Any discrepancies found are to be reported immediately to the Engineer.
2. BP Civils accepts no responsibility for inaccuracies in data provided by third parties such as topographic surveys or Ordnance Survey mapping.
3. Do not scale, work to figured dimensions only. All dimensions are in millimeters unless noted otherwise and all levels are in metres from the topographic survey datum.
4. Any information given regarding existing underground services is given in good faith after consultation with the relevant authority, however accuracy is not certain. The main contractor is responsible for checking all information on site prior to work commencing and taking due care whilst undertaking the works.
5. All dimensions to be checked on site. All details and dimensions relating to sub-contractors work must be checked and agreed between the sub-contractor or supplier and the general contractor.
6. The electronic information from this drawing can not be guaranteed as dimensionally drawn exact. Figured dimensions must be used for setting out and detailing. BP Civils logos and company information must be removed from copies if information is re-used.
7. Where used, this map is based on or reproduced from Ordnance Survey material with the permission of Ordnance Survey on behalf of the controller of His Majesty's Stationary Office (c) Crown Copyright. Licence number: 100022432. BP Civils accept no liability for any inaccuracies with the data.

P1	25/02/25	Minor adjustment of on-site drainage - topographic survey corrected by Surveyor
Rev.	Date	Amendments

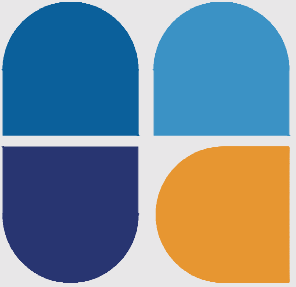

BP CIVILS
Infrastructure Design and Transport Planning Consultants
2 West Barn, Norton Lane, Chichester, West Sussex PO20 3AF
Tel: 01243 210418
www.bpcivils.co.uk enquiries@bpcivils.co.uk

Drawing Status	PLANNING NOT FOR CONSTRUCTION		
Client	A,G & J Steventon		
Project	10-12 Nelson Road, Bognor Regis		
Drawing Title	Existing Drainage		
Scale at A3	Date	Drawn By	Checked By
1:1000	Feb. '24	SPB	MJA
Drawing Code	Drawing No.		Rev.
000-BPC-WD-ZZ-D-C	PL300		P1

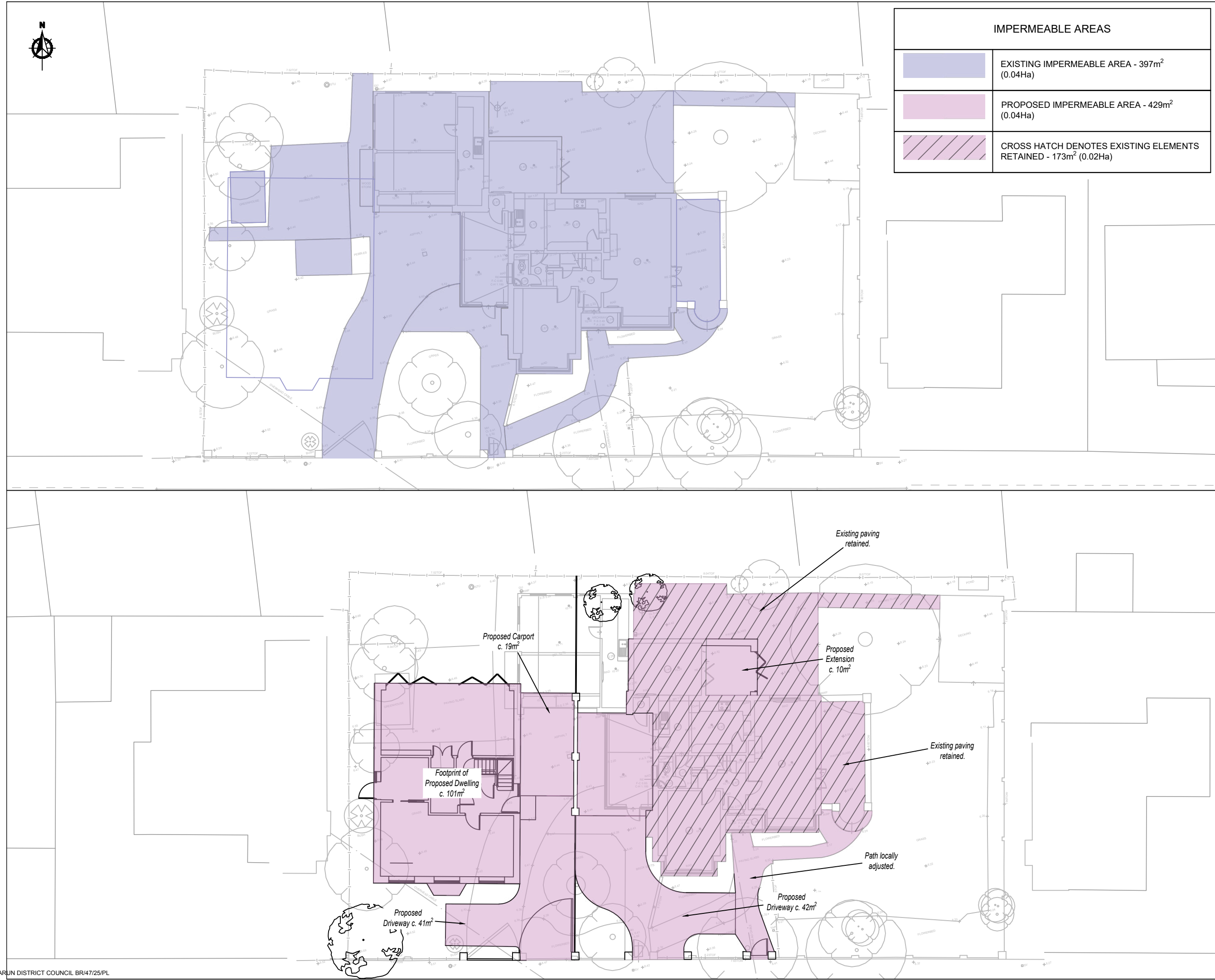

IMPERMEABLE AREAS	
	EXISTING IMPERMEABLE AREA - 397m ² (0.04Ha)
	PROPOSED IMPERMEABLE AREA - 429m ² (0.04Ha)
	CROSS HATCH DENOTES EXISTING ELEMENTS RETAINED - 173m ² (0.02Ha)

- NOTES
- A3
1.

This drawing is to be read in conjunction with all other BP Civils drawings, and with all relevant Architect's and Engineer's drawings and specification. Any discrepancies found are to be reported immediately to the Engineer.
2.

BP Civils accepts no responsibility for inaccuracies in data provided by third parties such as topographic surveys or Ordnance Survey mapping.
3.

Do not scale, work to figured dimensions only. All dimensions are in millimeters unless noted otherwise and all levels are in metres from the topographic survey datum.
4.

Any information given regarding existing underground services is given in good faith after consultation with the relevant authority, however accuracy is not certain. The main contractor is responsible for checking all information on site prior to work commencing and taking due care whilst undertaking the works.
5.

All dimensions to be checked on site. All details and dimensions relating to sub-contractors work must be checked and agreed between the sub-contractor or supplier and the general contractor.
6.

The electronic information from this drawing can not be guaranteed as dimensionally drawn exact. Figured dimensions must be used for setting out and detailing. BP Civils logos and company information must be removed from copies if information is re-used.
7.

Where used, this map is based on or reproduced from Ordnance Survey material with the permission of Ordnance Survey on behalf of the controller of His Majesty's Stationary Office (c) Crown Copyright. Licence number: 100022432. BP Civils accept no liability for any inaccuracies with the data.

P1	25/02/25	Topographic survey corrected by Surveyor
Rev.	Date	Amendments

BP CIVILS

Infrastructure Design and Transport Planning Consultants
2 West Barn, Norton Lane, Chichester, West Sussex PO20 3AF
Tel: 01243 210418
www.bpcivils.co.uk enquiries@bpcivils.co.uk

Drawing Status	PLANNING NOT FOR CONSTRUCTION		
Client	A,G & J Steventon		
Project	10-12 Nelson Road, Bognor Regis		
Drawing Title	Impermeable Areas		
Scale at A3	Date	Drawn By	Checked By
1:200	Feb. '24	SPB	MJA
Drawing Code	Drawing No.	Rev.	
000-BPC-WD-ZZ-D-C	PL400	P1	
Project No.		D2349	

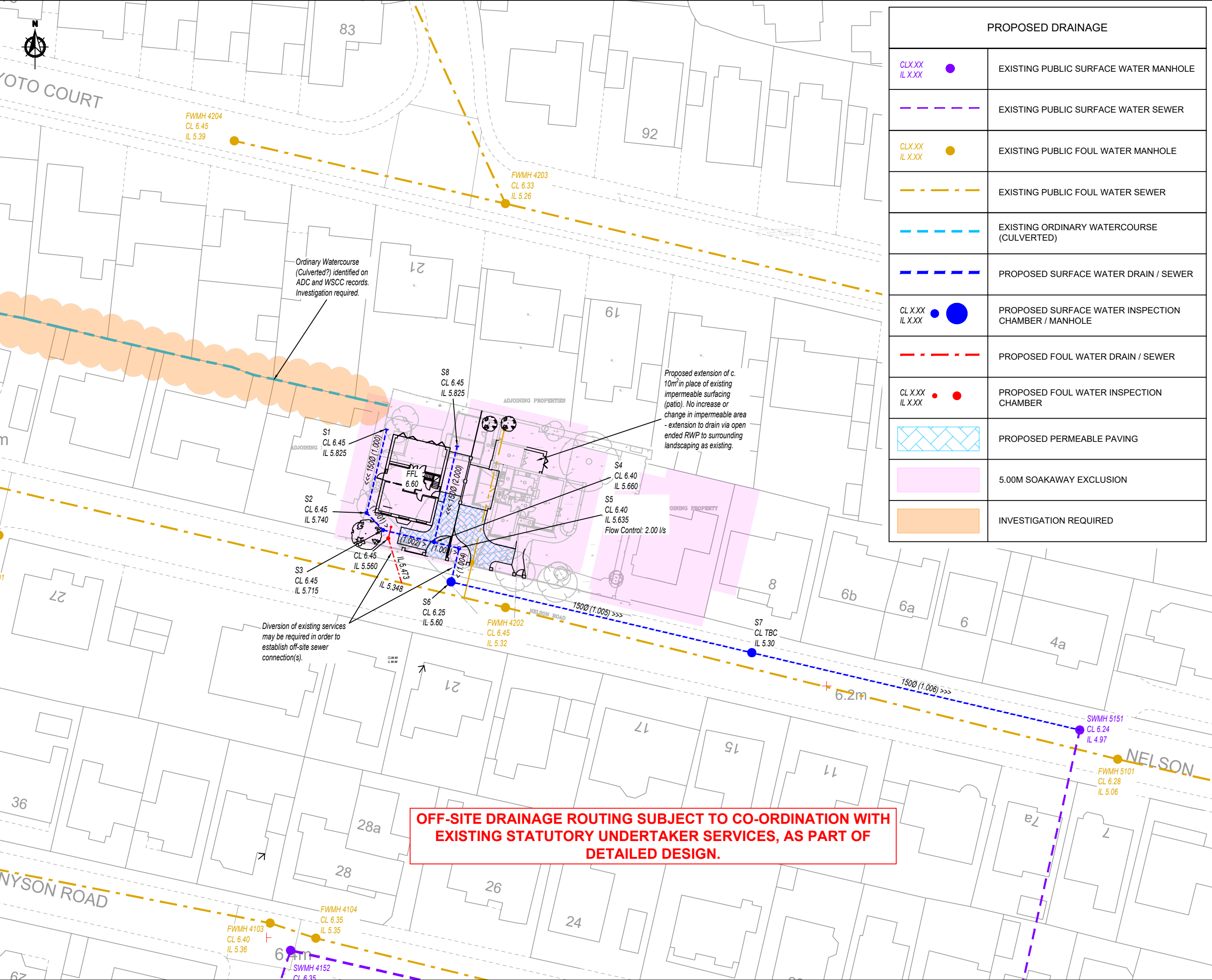

PROPOSED DRAINAGE	
<div>CLX.XX IL X.XX</div> <div></div>	EXISTING PUBLIC SURFACE WATER MANHOLE
<div></div> <div></div>	EXISTING PUBLIC SURFACE WATER SEWER
<div>CLX.XX IL X.XX</div> <div></div>	EXISTING PUBLIC FOUL WATER MANHOLE
<div></div> <div></div>	EXISTING PUBLIC FOUL WATER SEWER
<div></div> <div></div>	EXISTING ORDINARY WATERCOURSE (CULVERTED)
<div></div> <div></div>	PROPOSED SURFACE WATER DRAIN / SEWER
<div>CL X.XX IL X.XX</div> <div></div>	PROPOSED SURFACE WATER INSPECTION CHAMBER / MANHOLE
<div></div> <div></div>	PROPOSED FOUL WATER DRAIN / SEWER
<div>CL X.XX IL X.XX</div> <div></div>	PROPOSED FOUL WATER INSPECTION CHAMBER
<div></div> <div></div>	PROPOSED PERMEABLE PAVING
<div></div> <div></div>	5.00M SOAKAWAY EXCLUSION
<div></div> <div></div>	INVESTIGATION REQUIRED

NOTES

A3

1. This drawing is to be read in conjunction with all other BP Civils drawings, and with all relevant Architect's and Engineer's drawings and specification. Any discrepancies found are to be reported immediately to the Engineer.

2. BP Civils accepts no responsibility for inaccuracies in data provided by third parties such as topographic surveys or Ordnance Survey mapping.

3. Do not scale, work to figured dimensions only. All dimensions are in millimeters unless noted otherwise and all levels are in metres from the topographic survey datum.

4. Any information given regarding existing underground services is given in good faith after consultation with the relevant authority, however accuracy is not certain. The main contractor is responsible for checking all information on site prior to work commencing and taking due care whilst undertaking the works.

5. All dimensions to be checked on site. All details and dimensions relating to sub-contractors work must be checked and agreed between the sub-contractor or supplier and the general contractor.

6. The electronic information from this drawing can not be guaranteed as dimensionally drawn exact. Figured dimensions must be used for setting out and detailing. BP Civils logos and company information must be removed from copies if information is re-used.

7. Where used, this map is based on or reproduced from Ordnance Survey material with the permission of Ordnance Survey on behalf of the controller of His Majesty's Stationary Office (c) Crown Copyright. Licence number: 100022432. BP Civils accept no liability for any inaccuracies with the data.

P1	25/02/25	Topographic survey corrected by Surveyor
Rev.	Date	Amendments

BP CIVILS

Infrastructure Design and Transport Planning Consultants
2 West Barn, Norton Lane, Chichester, West Sussex PO20 3AF
Tel: 01243 210418
www.bpcivils.co.uk enquiries@bpcivils.co.uk

Drawing Status

PLANNING
NOT FOR CONSTRUCTION

Client

A,G & J Steventon

Project

10-12 Nelson Road,
Bognor Regis

Drawing Title

Conceptual Drainage Strategy

Scale at A3	Date	Drawn By	Checked By	Project No.
1:500	Feb. '24	SPB	MJA	D2346

Drawing Code	Drawing No.	Rev.
000-BPC-WD-ZZ-D-C	PL500	P1

OFF-SITE DRAINAGE ROUTING SUBJECT TO CO-ORDINATION WITH EXISTING STATUTORY UNDERTAKER SERVICES, AS PART OF DETAILED DESIGN.