

Supplied by Streetwise Maps Ltd
 www.streetwise.net
 Licence No: 100047474
 16:11:37 17/02/2026

LOCATION PLAN @ 1:1250
 Licence No. 100047474
 Application site shown in red

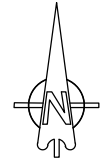

INDICATIVE

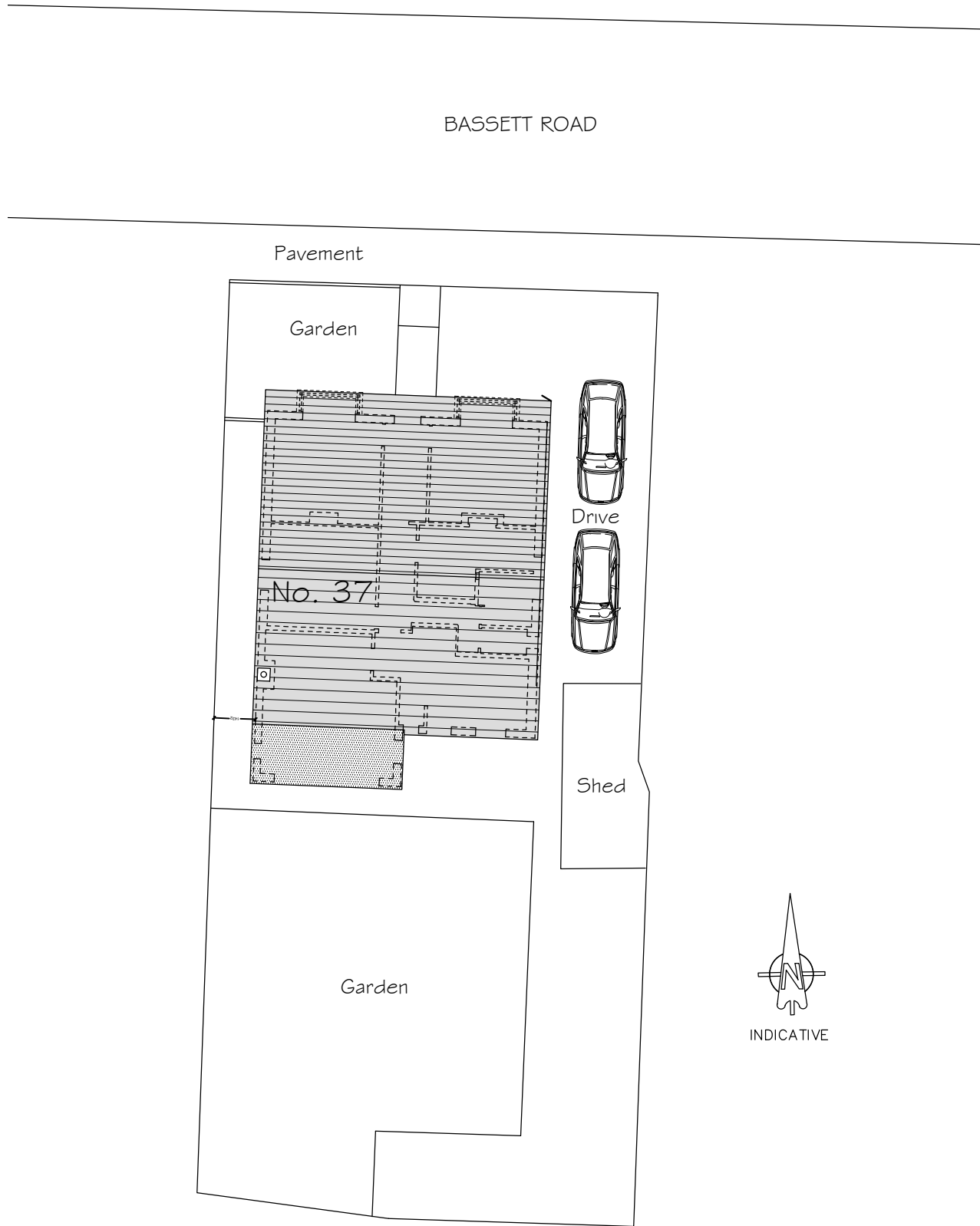

EXISTING SITE PLAN @ 1:200

Scale 1:200

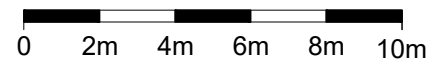

NOTES:

ALL DIMENSIONS TO BE CHECKED ON SITE AND VERIFIED PRIOR TO COMMENCING WORKS/MANUFACTURE. ANY DISCREPANCIES TO BE REPORTED TO NOUVEAU ARCHITECTURE

THIS DRAWING IS PROTECTED BY COPYRIGHT. IT MAY NOT BE REPRODUCED IN ANY FORM OR BY ANY MEANS FOR ANY PURPOSE WITHOUT THE WRITTEN PERMISSION OF NOUVEAU ARCHITECTURE

ISSUED FOR PLANNING PURPOSES ONLY

| Rev | Date | Description |
|-----------|------|-------------|
| Revisions | | |

CLIENT:

Mrs H Smit
 Many Rooms Ltd
 13 Southdown Road
 Bognor Regis
 West Sussex PO21 2JS

PROJECT:

Alterations & Extensions
 37 Bassett Road
 Bognor Regis
 West Sussex
 PO21 2JH

DRAWING TITLE:

Existing Site Plan and Location Plan

PLANNING APPLICATION

NOUVEAU ARCHITECTURE

9 Bere Lane
 Knowle Village
 Hampshire
 PO17 5GL
 Tel: 01329 833396
 Email: info@nouveau-architecture.co.uk
 Web: www.nouveau-architecture.co.uk



| | |
|-------------|---------------|
| SCALE: | As shown @ A3 |
| DATE: | Jan 2026 |
| DRAWN: | CW |
| CHECKED BY: | |
| DRAWING NO: | |

| | | |
|------|------|---|
| N443 | PL01 | * |
|------|------|---|