

Notes

CDM REGULATIONS 2015
The client must abide by the Construction Design and Management Regulations 2015. The client must appoint a contractor. If more than one contractor is to be involved, the client will need to appoint (in writing) a principal designer (to plan, manage and coordinate the planning and design work) and a principal contractor (to plan, manage and coordinate the construction and ensure there are arrangements in place for managing and organising the project).

Domestic clients
The domestic client is to appoint a principal designer and a principal contractor when there is more than one contractor, if not your duties will automatically transferred to the contractor or principal contractor.

The designer can take on the duties, provided there is a written agreement between you and the designer to do so.

The Health and Safety Executive is to be notified as soon as possible before construction work starts if the works:

- (a) Last longer than 30 working days and has more than 20 workers working simultaneously at any point in the project.
- Or:
- (b) Exceeds 500 person days.

All contractors/sub-contractors must ensure that they are in possession of the currently issued drawings and details before commencing the relevant work-stage. All measurements to be checked before signs, any discrepancies must be reported to sign design details alterations can be made prior to commencement of building works.

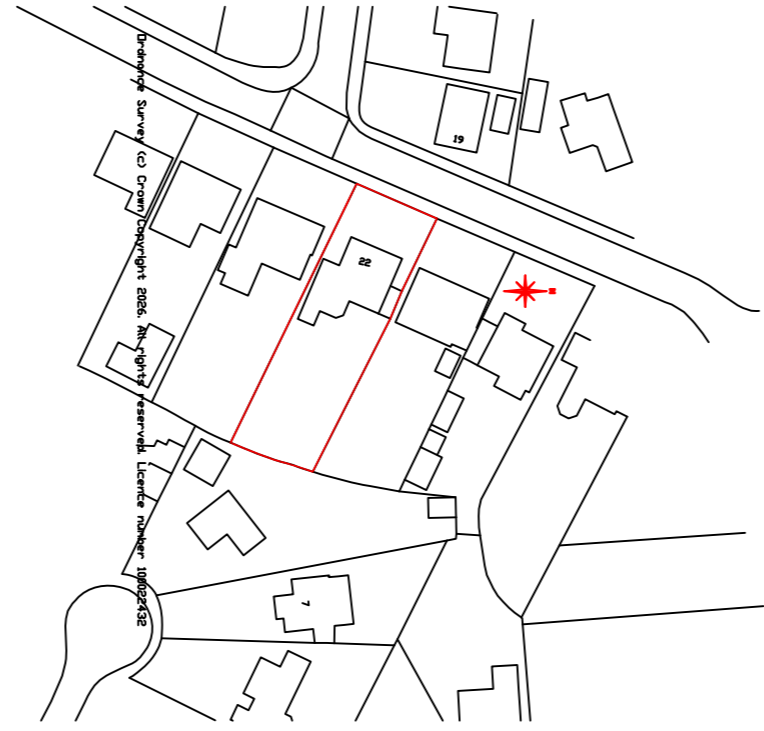

No.	Revision/Issue	Date.



MULBERRY ARCHITECTURE LTD
Info@mulberryg.co.uk
01243 824814

22 Sefton Avenue
Rose Green
Bognor Regis
West Sussex
PO21 3BN

Proposed Dormer and Internal Alterations
Date January 2026
Scale 1:200 1:1250