

1. This drawing is to be read in conjunction with all other Bright Plan drawings, and with all relevant Architect's and Engineer's drawings and specification. Any discrepancies found are to be reported immediately to the Engineer.
2. Bright Plan accepts no responsibility for inaccuracies in data provided by third parties such as topographic surveys or Ordnance Survey mapping.
3. Road markings are indicative, based on aerial imagery when not provided within a topographical survey. Bright Plan accepts no responsibility for discrepancies in aerial imagery.
4. Do not scale, work to figured dimensions only. All dimensions are in millimeters unless noted otherwise and all levels are in metres from the topographic survey datum.
5. Any information given regarding existing underground services is given in good faith after consultation with the relevant authority, however accuracy is not certain.

Existing Road Markings

-Swept Path-
Wheel Track
Over Swing

Iveco Van Daily 35C 12/15/18 (w/b 3.95m)

7.012m
1.996m
2.335m
0.1354m
1.996m
6.00s
6.550m

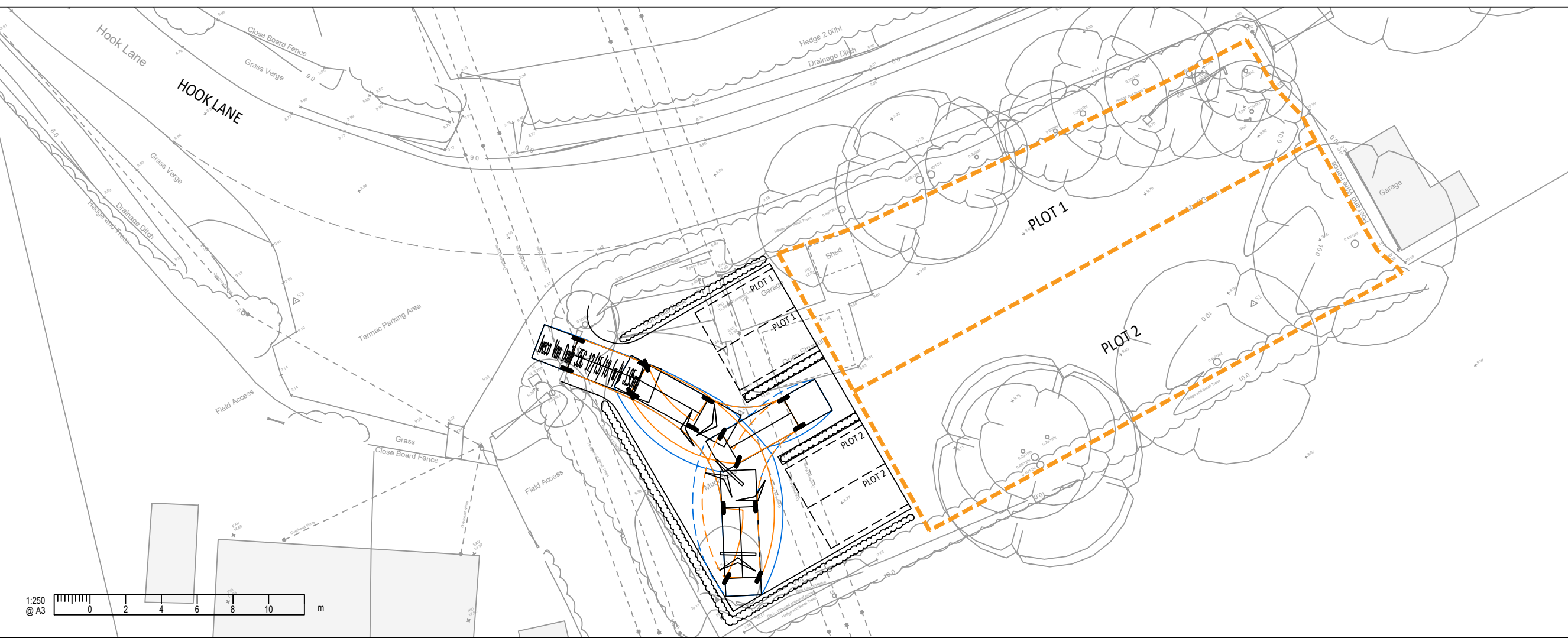
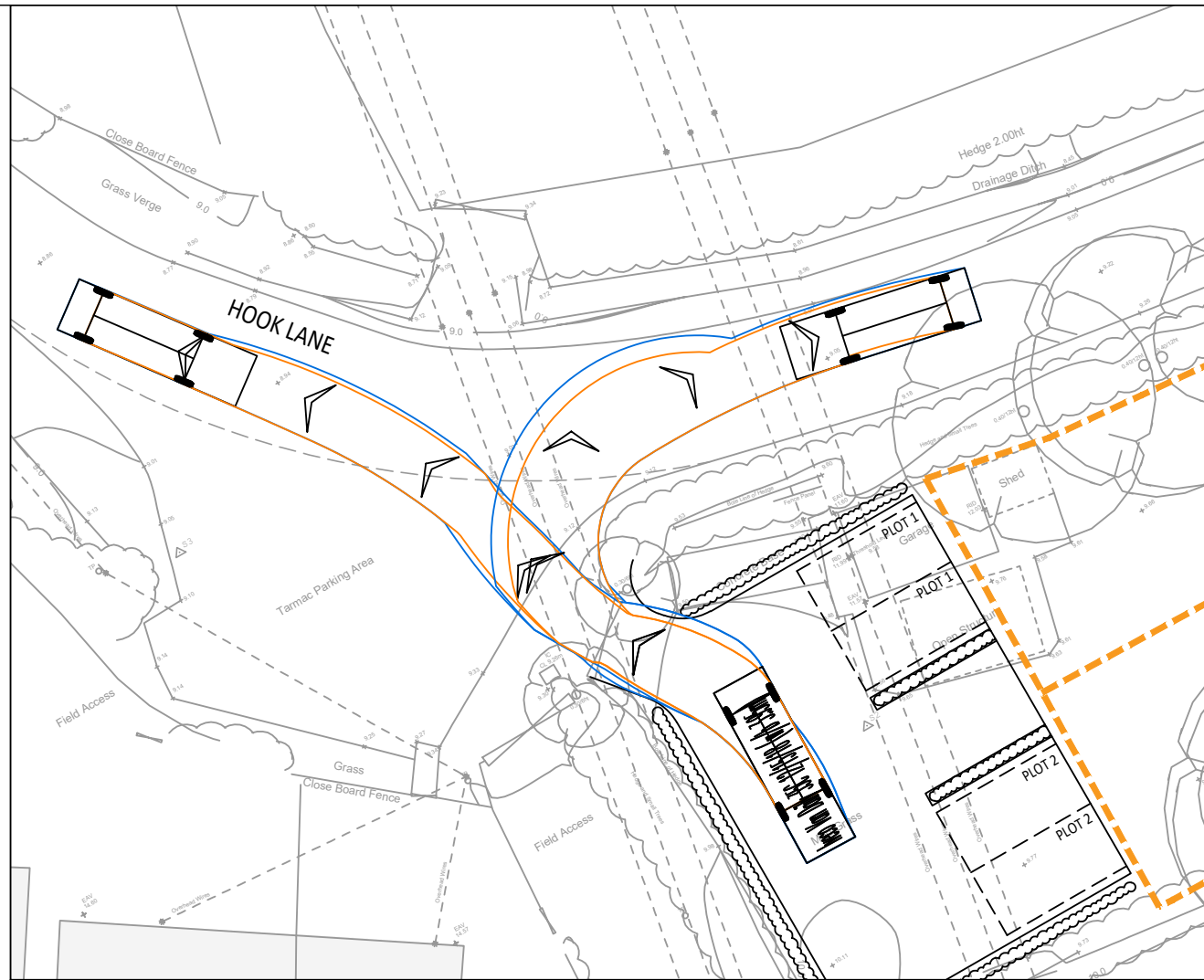
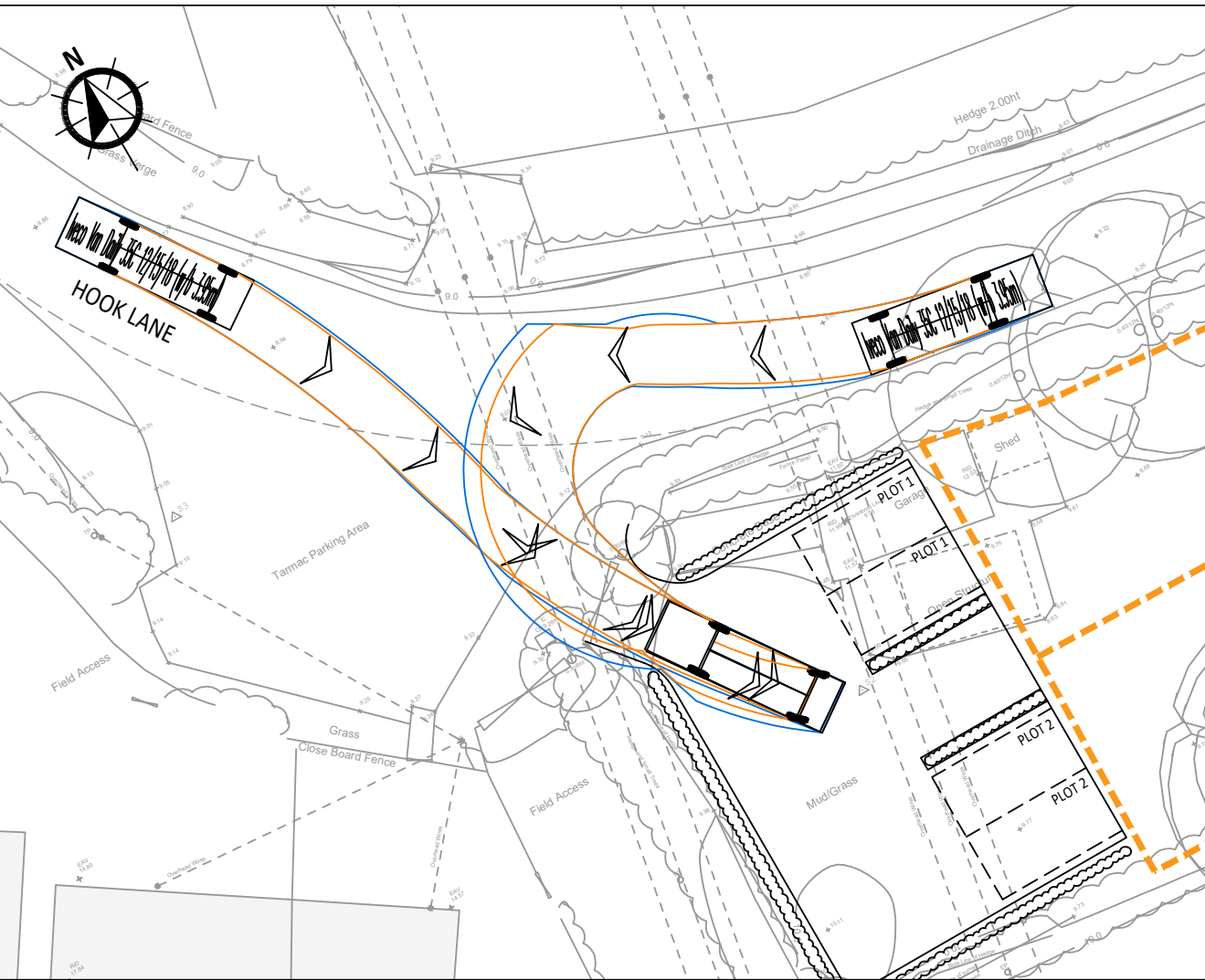

A	Revised Layout	17/06/2024
-	Original Issue	11/06/2024
Rev.	Amendments	Date



BRIGHT PLAN
 Transport Planning | Civil Engineering | Landscape Design
 65 Chichester Enterprise Centre, Terminus Road, Chichester, PO19 8FY
 Tel: 0333 358 3270 Email: enquiries@bpcivils.co.uk
 www.bpcivils.co.uk

Drawing Status **Draft**

Client **Mr P. Homewood**

Project **Hook Lane, Aldingbourne**

Drawing Title **Delivery Van Servicing**

Scale 1:250	Date Jun 24	Drawn By SMO	Checked PMR
----------------	----------------	-----------------	----------------

Drawing No. 2024-6645-005	Rev. A
------------------------------	-----------

