

- ### EXTERNAL LEVELS LEGEND
- EXISTING FEATURES**
- + 00.000 EXISTING INTERPOLATED SURFACE LEVEL
- PROPOSED FEATURES**
- TRANSITION KERB
 - SLOPE / EMBANKMENT SURFACE
 - FALL → FALL IN SURFACE AND GRADIENT
 - + [00.000] SURFACE LEVEL
- PROPOSED SURFACE LEVELS ABBREVIATIONS**
- CD CHANNEL DRAIN COVER LEVEL
 - RG ROAD GULLY COVER LEVEL
 - BOK BOTTOM OF KERB
 - TOK TOP OF KERB
- WARNING SIGN LEGEND**
- INDICATES RISKS REQUIRING THE FOLLOWING
- SPECIAL ATTENTION BY THE CONTRACTOR
 - CONSTRUCTION WARNING
 - HAND DIG CONSTRUCTION

- ### NOTES
- #### EXTERNAL WORKS GENERAL
- H2 KERBS UPSTANDS TO BE 100mm. FOR BN KERB UPSTANDS REFER TO DRAWING LEGEND. EF EDGINGS TO BE USED AT THE BACK OF FOOTWAYS/VERGES.
 - KERBS SHALL BE PRECAST CONCRETE KERBS COMPLYING WITH BS EN 1340 AND THE FOLLOWING:
 - WEATHERING RESISTANCE: CLASS 3
 - BENDING STRENGTH: CLASS 2
 - ABRASION RESISTANCE: CLASS 3.
 - SLIP/SKID RESISTANCE: MIN P.P.T.V. 45 TO BS 7932.
 - ALL FOOTWAYS WITH A WIDTH GREATER THAN 1.8m ARE TO BE MACHINE LAID.
 - MIX ST1 CONCRETE KERB BEDDING TO CLAUSE 2602SR SHALL BE LAID ON SUBBASE AND SHALL BE A MINIMUM THICKNESS OF 150. SUBBASE SHALL BE EXCAVATED WHERE NECESSARY TO ACHIEVE 150 THICKNESS. RECOMPACT DISTURBED SUBBASE PRIOR TO CONSTRUCTION OF KERB BASE.
 - WHERE EXCAVATION INTO EXISTING CARRIAGEWAY IS REQUIRED A TRENCH SHALL BE EXCAVATED OF SUFFICIENT DEPTH AND WIDTH TO ACCOMMODATE THE COMPLETE BED AND BACKING OF THE KERB TYPE SCHEDULED. REFER TO THE LOCAL HIGHWAYS AUTHORITIES STANDARD DETAILS.
 - AS DESCRIBED IN CLAUSE 1101, SUB-CLAUSE 1, KERBS MAY BE LAID AND BEDDED ON MORTAR OR LAID DIRECTLY ONTO STILL PLASTIC CONCRETE BED AS ILLUSTRATED HERE.
 - THE APPROPRIATE 914mm LONG PRECAST CONCRETE TRANSITION KERB SHALL BE INSTALLED AT EACH CHANGE IN KERB TYPE, TIE-INS TO EXISTING AND AT TERMINATIONS.
 - THE MINIMUM LENGTH OR ANY CUT KERB SHALL BE 450mm.
 - SOFT SPOTS IN THE FORMATION ARE TO BE REMOVED AND REPLACED WITH SUITABLE MATERIAL.
 - ALL EXISTING MANHOLE COVERS, GULLYS ETC. ARE TO BE RAISED TO SUITE PROPOSED LEVELS.
 - RE-GRADING AND EMBANKMENTS ARE TO HAVE A MAXIMUM SLOPE GRADIENT OF 1:3.
 - ALL PROPOSED SIGNING AND LINING, AND ANY EXISTING TO BE REINSTATED, IS TO BE IN ACCORDANCE WITH THE TRAFFIC SIGNS REGULATIONS AND GENERAL DIRECTIONS 2016 AND TO THE SATISFACTIONS OF THE HIGHWAYS INSPECTOR.
 - NO BLOCKS/SLABS WITH A UNIT WEIGHT IN EXCESS OF 20kg TO BE USED.
 - KERBS IN EXCESS OF 20kg ARE TO BE MACHINE LAID.

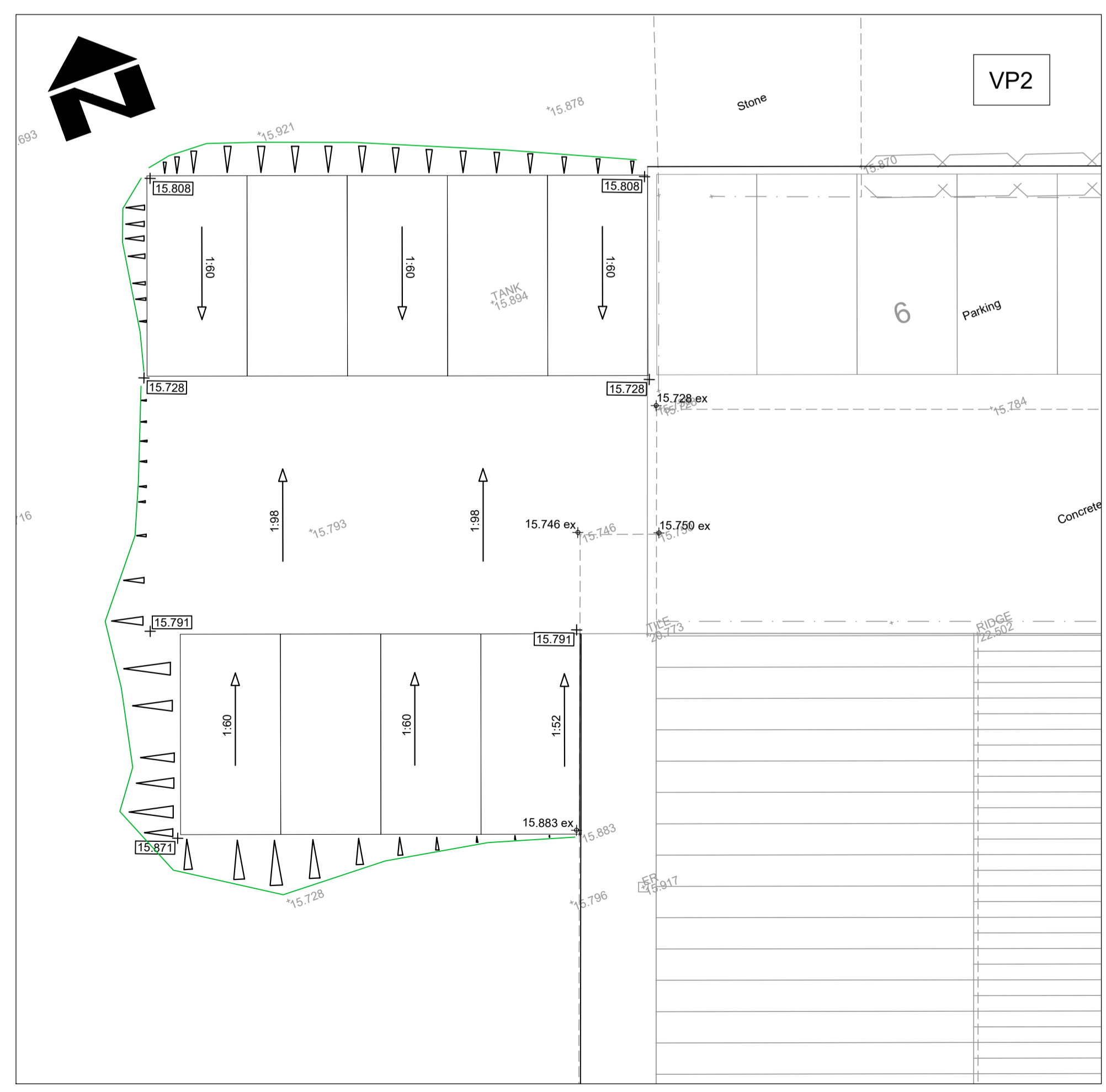
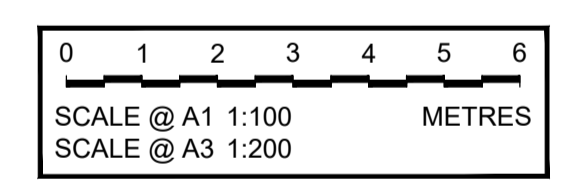

FOR CONTINUATION SEE DRAWING P27002-LRW-XX-XX-DR-C-7702

FOR CONTINUATION SEE DRAWING P00000-ECH-XX-XX-DR-0000

IMPORTANT NOTE: CAUTION
 ALL INFORMATION SHOWN ON THIS DRAWING FOR UNDERGROUND SERVICES/STATUTORY UNDERTAKERS' PLANT IS APPROXIMATE AND IS PROVIDED FOR THE CONTRACTORS' INFORMATION ONLY. IT SHOULD NOT BE RELIED ON FOR EXCAVATION OR ANY OTHER WORKS PURPOSES AND CONTRACTORS MUST SATISFY THEMSELVES OF THEIR LOCATIONS PRIOR TO THE COMMENCEMENT OF WORKS.

PLANNING

PARTS OF THIS DRAWING SHOULD BE SHOWN IN COLOUR. IF THIS NOTE IS NOT RED REPRINT A COLOURED COPY

© CROWN COPYRIGHT AND DATABASE RIGHTS 2025
 ORDANCE SURVEY 100019180

P02	PLANNING ISSUE	14.10.25	LW	N.K	LW
P01	PLANNING ISSUE	19.09.25	LW	N.K	LW
REV	AMENDMENTS	DATE	CAD	CHK D	APPD
 <small>email: admin@lrwcivildesigns.com tel: 07799 907484 85, Crooked Lane, Birphen, Chichester, West Sussex, PO20 7ET</small>					
BIO DOT CLIENT					
ERECTION OF A COMMERCIAL BUILDING (WITHIN USE CLASS E(G)) PARKING, LANDSCAPING AND OTHER ASSOCIATED WORK JOB TITLE					
PROPOSED EXTERNAL LEVELS PLAN SHEET 1 of 2 DRAWING TITLE					
DRAWN	ENGINEER	CHECKED	APPROVED		
N.K	L.W	J.S	L.W		
DATE	SCALE @ A1	SCALE @ A3	STATUS		
19.09.2025	1:100 @ A1		A		
JOB NO.	DRAWING NO.	REV.			
P27002	LRW/XX/XX/DR/C/7701	P02			