

6. CONCEPT

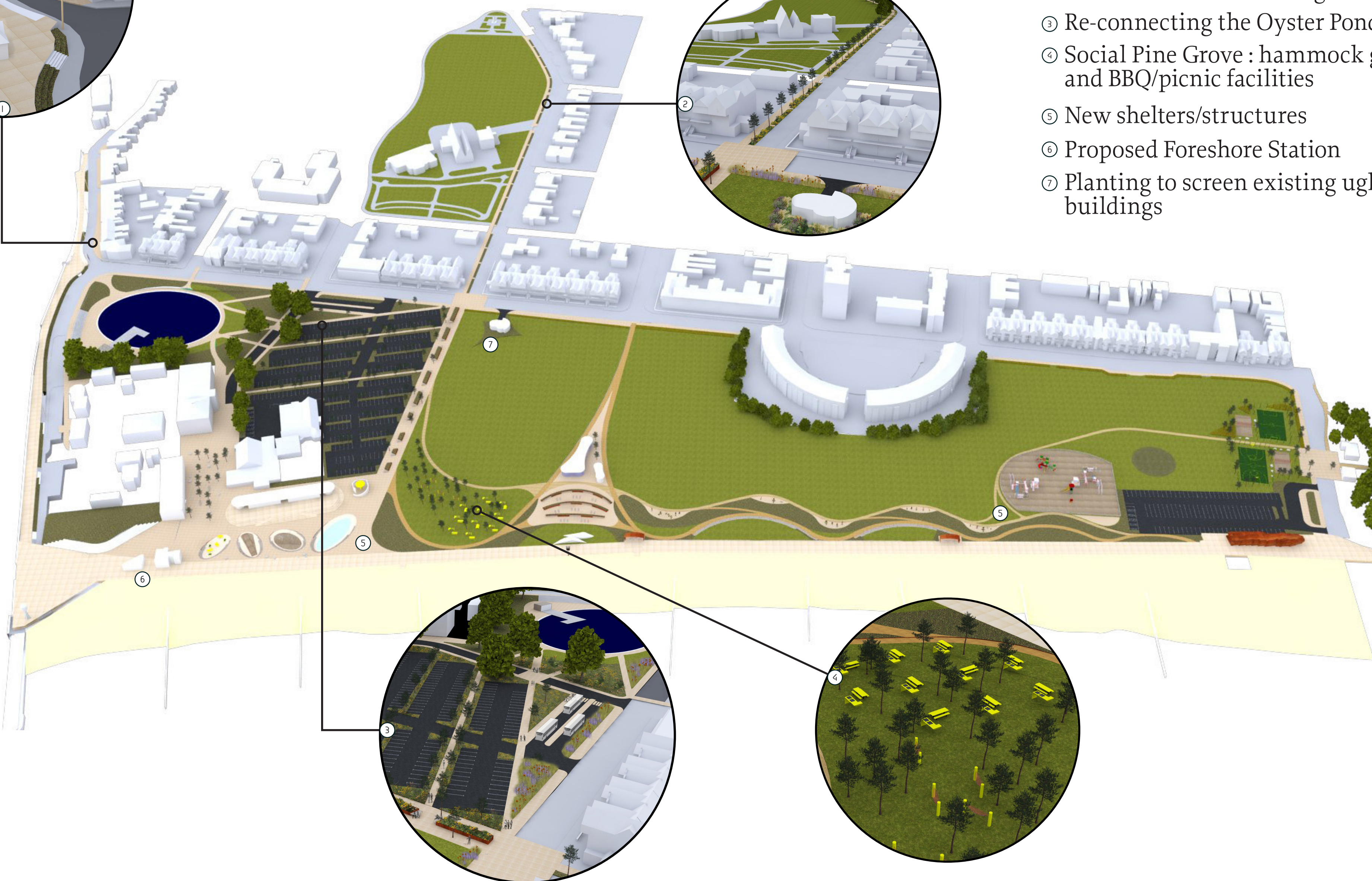

- ① Pier Road : Reduced road width to single carriageway, allowing cafe spill out and alfresco dining experiences
- ② Beach Road : Continuation of the 'Grand Procession' connecting the War Memorial with the greens
- ③ Re-connecting the Oyster Pond
- ④ Social Pine Grove : hammock garden and BBQ/picnic facilities
- ⑤ New shelters/structures
- ⑥ Proposed Foreshore Station
- ⑦ Planting to screen existing ugly buildings

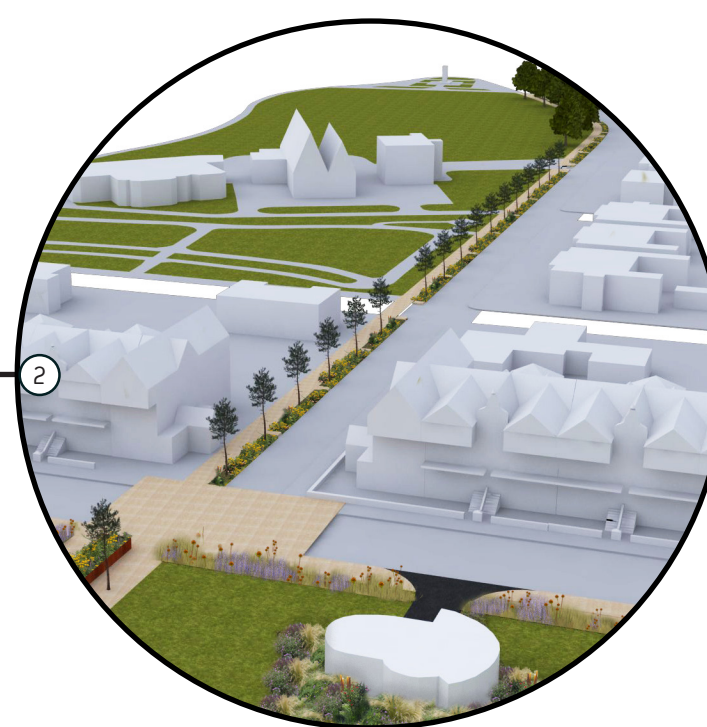
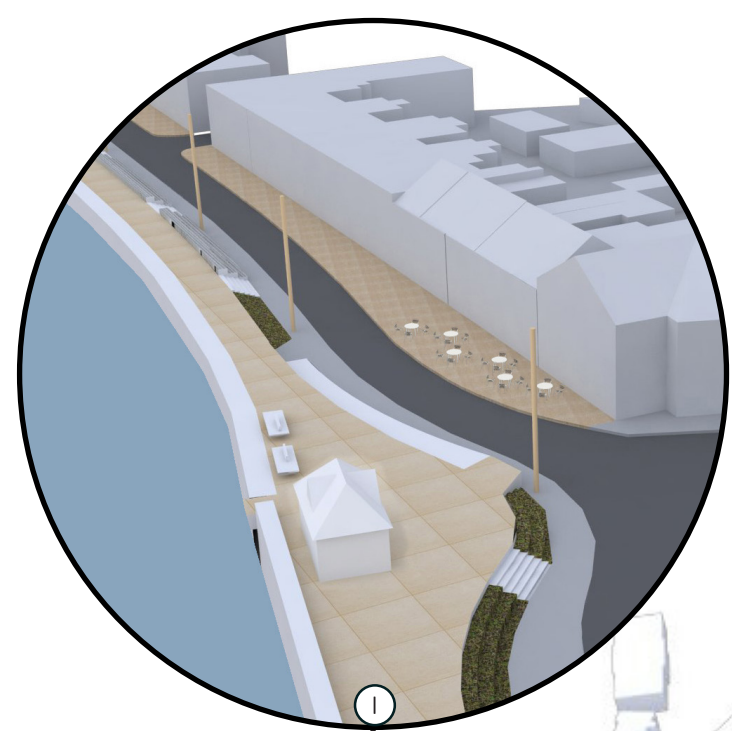
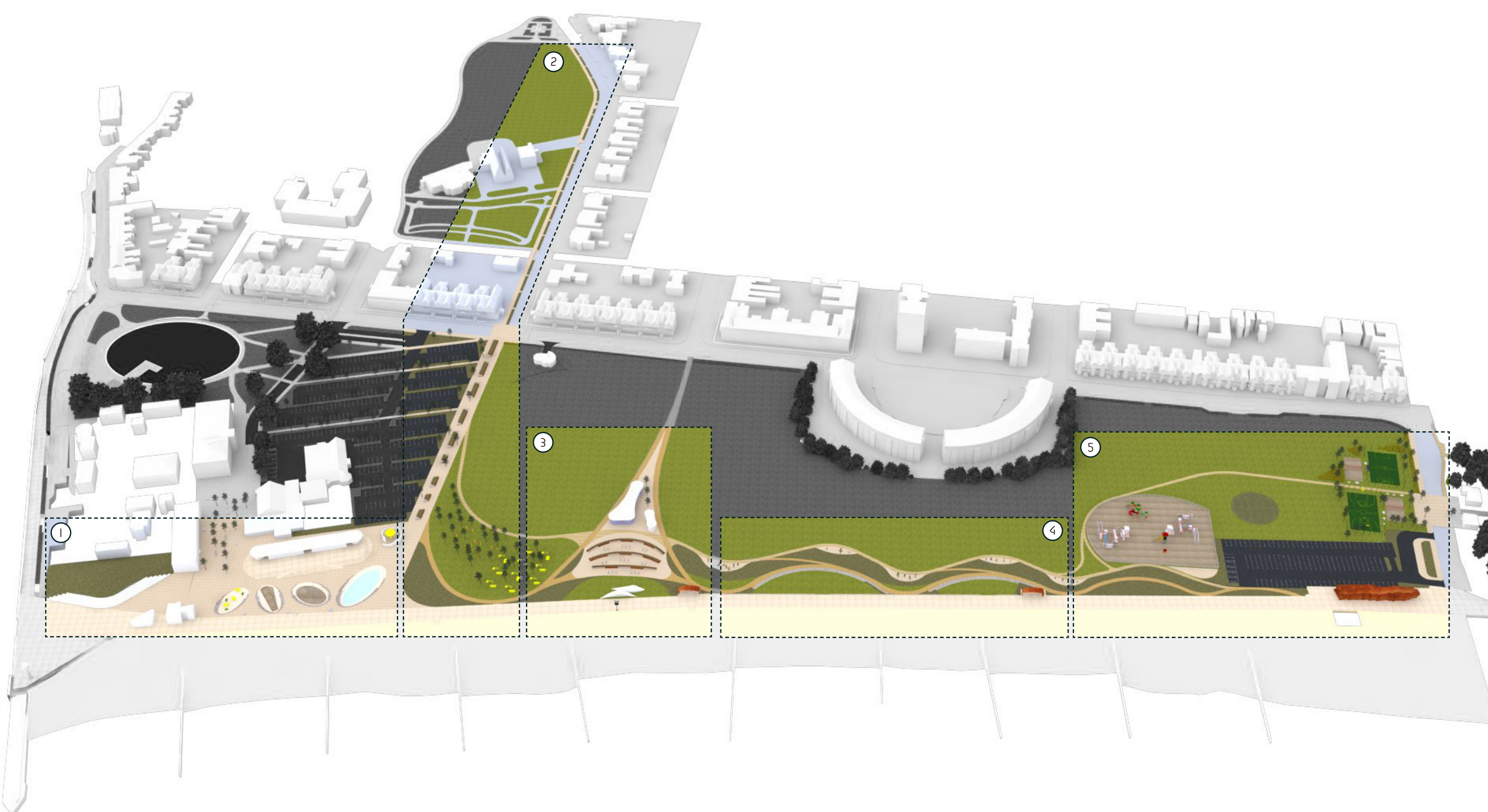
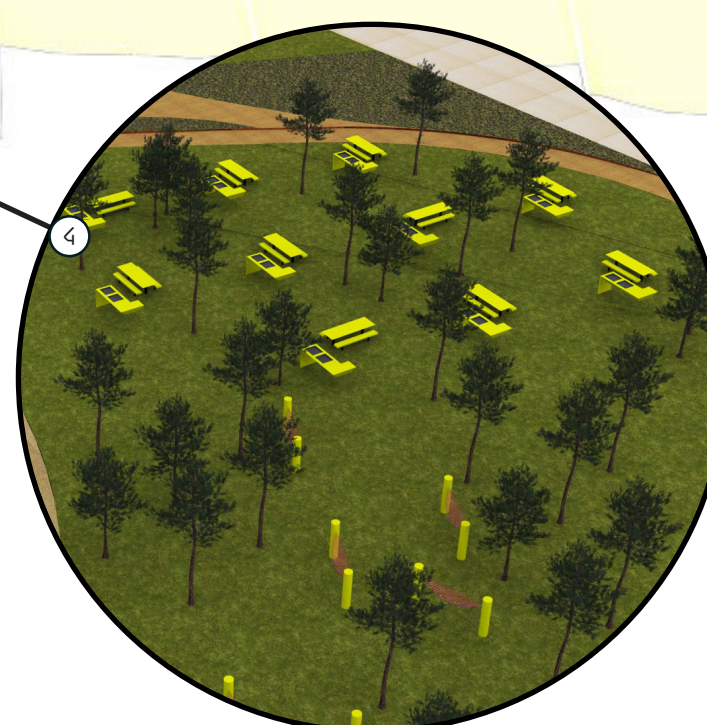

- ① Social Hub
- ② Grand Procession
- ③ Performance Hub
- ④ Coastal Gardens
- ⑤ Active Hub